



Turbine Series Technical Information

Mobile and Marine Applications

aerospace
climate control
electromechanical
filtration
fluid & gas handling
hydraulics
pneumatics
process control
sealing & shielding



WARNING: The products described in this literature can expose you to chemicals including Diisononyl phthalate, Carbon black extract, which are known to the State of California to cause cancer. For more information go to www.P65Warnings.ca.gov.

ENGINEERING YOUR SUCCESS.

Table of Contents

Turbine Series Cut Sheets

COVER	1
Table of Contents	2
Turbine Series - 500FG	3-4
Turbine Series - 500MA/500MAM	5-6
Turbine Series - 900FH/1000FH	7-8
Turbine Series - 900/1000MA-MAM	9-10
Turbine Series - 75500FGX	11-12
Turbine Series - 75500MAX-MAXM	13-14
Turbine Series - 75900/1000FHX	15-16
Turbine Series - 75900/1000MAX/M/P	17-18
Turbine Series - 751000MAV-MAVM	19-20
Turbine Series - 731000FH	21-22
Turbine Series - 731000MA-MAM	23-23
Turbine Series - 771000MA-MAM	25-24
Turbine Series - 771000FH	27-28
Turbine Series - 791000FHV	29-30
Turbine Series - 791000MAV-MAVM	31-32

Turbine Series - 500FG

FUEL

Specifications:

Height: 11.45" (29.08 cm)
Width: 4.15" (10.5 cm)
 with Bracket 6.5" (16.51 cm)
Depth: 4.15" (10.5 cm)
 with Bracket 5.17" (13.13 cm)
Weight: 4.0 lbs (1.8 kg)
Ports: 3/4"-16 UNF (SAE J1926)
Service Clearance (Top): 4.0" (10.16 cm)
Vacuum Installation Recommended
Maximum Pressure: 15 psi (1.03 bar)
Max Flow Rate: 60 gph (227 lph)

Create a Part Number

Housing Type	Heater Option	Filtration Rating
Turbine Model Standard 3/4"-16 Ports	12 VDC Heater (100 watt) 24 VDC Heater (100 watt)	2 micron 10 micron 30 micron
500FG	12 24	2 10 30

Dimensions:

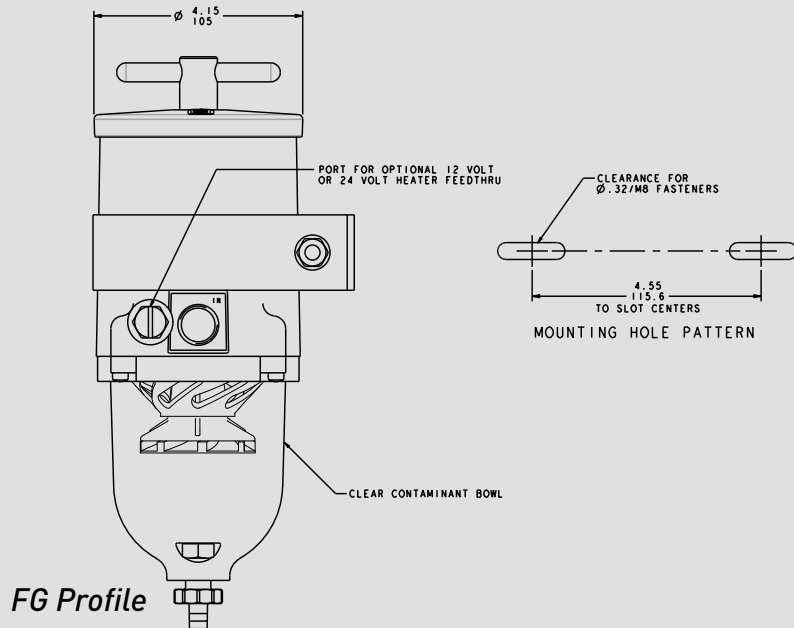
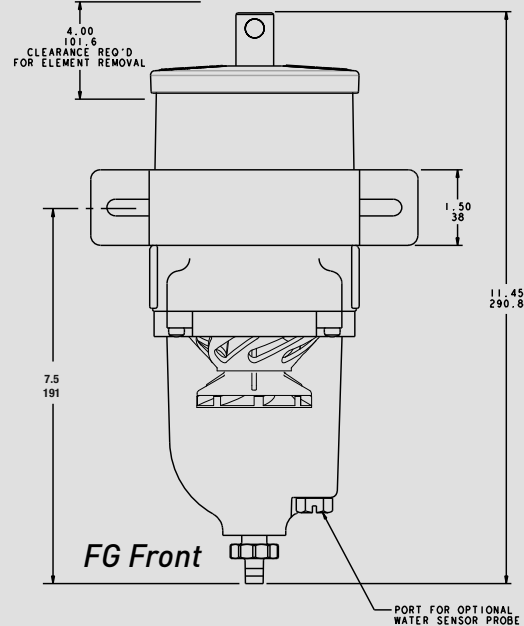
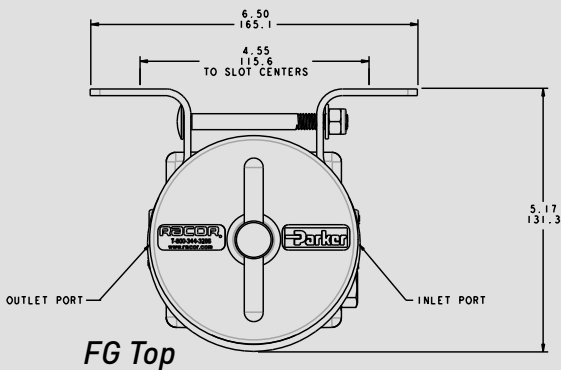

ASSEMBLY	DESCRIPTION
500FG2	500 Turbine Assy., 2 micron Filter
500FG10	500 Turbine Assy., 10 micron Filter
500FG30	500 Turbine Assy., 30 micron Filter
500FG1230	500 Turbine Assy., 12VDC Heater, 30 micron Filter
500FG242	500 Turbine Assy., 24VDC Heater, 2 micron Filter
500FG2430	500 Turbine Assy., 24VDC Heater, 30 micron Filter

RACOR®

SINGLE ASSEMBLY



PARTS

Turbine - 500FG

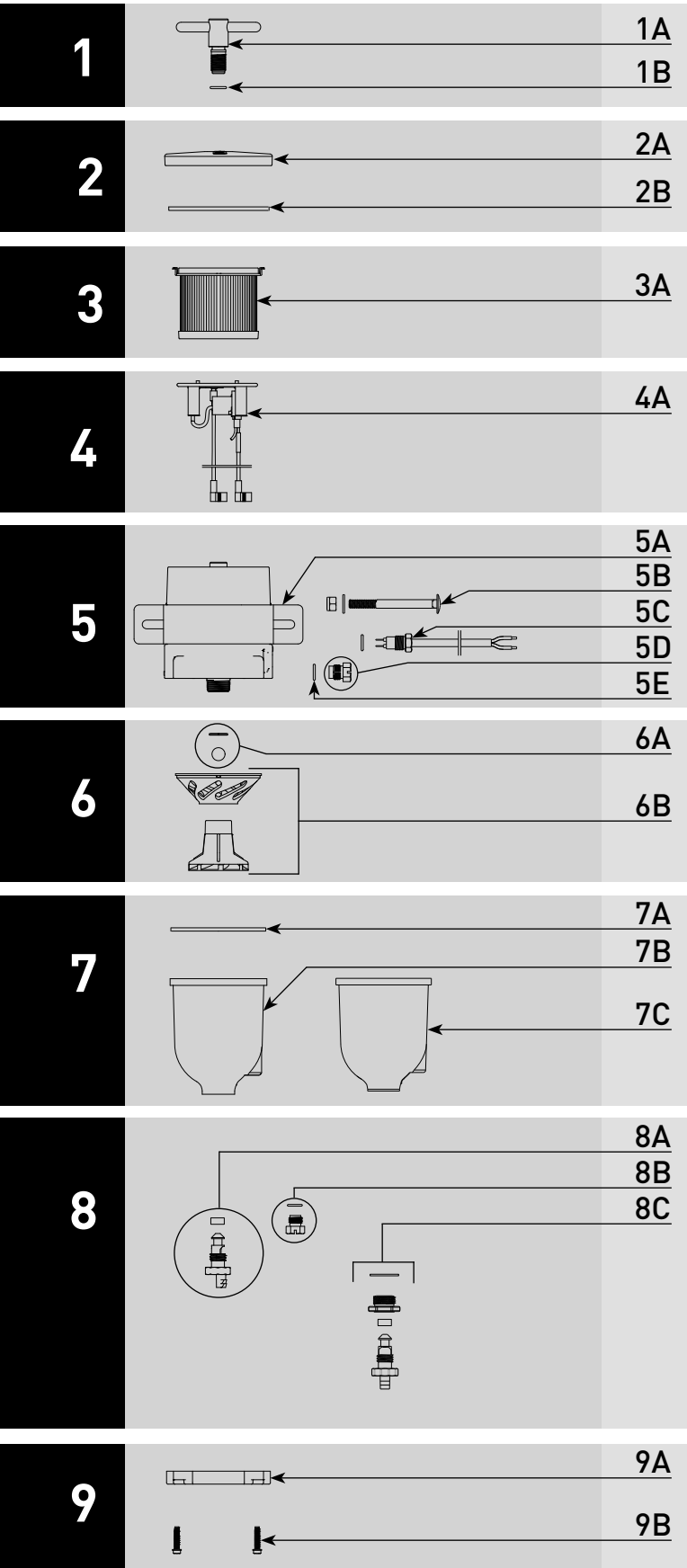

Part #	Description	
1A	RK23183 RK19671	T-handle Kit - Includes 1B and 2B Optional - T-handle Vacuum Gauge Kit - For 500FG Assemblies Manufactured After 2002
	1B	T-handle O-ring
2A	RK 15078	500FG Lid Kit - Includes 1B and 2B
2B		Lid Gasket - Included in 10A
3A	2010SM-OR 2010TM-OR 2010PM-OR	Replacement Element 2 micron - Includes 1B and 2B Replacement Element 10 micron - Includes 1B and 2B Replacement Element 30 micron - Includes 1B and 2B
4A	RK15438-01 RK15440-02	Heater Kit - 12 vdc, 100 watt - <i>Use with 10E</i> Heater Kit - 24 vdc, 100 watt - Includes 5C - <i>Use with 10E</i>
	5A	RK15441-01
5B	RK 11838	Carriage Bolt Kit - Includes (2) Bolt, (2) Washer, and (2) Nut
5C		Heater Feed-thru - Includes 5E
5D	RK 11-1679	Feed-thru Plug Kit - Includes 5E
5E		Feed-thru or Plug O-ring - Included in 10A
6A	RK 15010B	Checkball and Gasket Kit
6B	RK 15013D	Centrifuge and Baffle Kit - Includes 6A and 7A
7A	RK15374	Bowl Gasket - Included in 10A
7B	RK15405	Bowl Kit (2002 to Present) - Includes 7A, 8A and 8B **Bowl has 5/8"-11 drain port
7C	RK 15279-01	Bowl Kit (Before 2002) - Includes 7A and 8B **Bowl has 7/8"-14 drain port
8A		Self-venting Drain (2002 to Present - Included in 7B)
8B	RK 20126	Bowl Plug Kit
8C	RK 30488	Self-venting Drain Kit (Pre-2002 - <i>Use with 7C</i>)
9A	RK 15035	Bowl Ring Kit (FG - Tan) - Includes 7A
9B	RK 15081	Bowl Fasteners (set of 4)

Accessories and Parts Available (Not Shown)

10A	RK 15211	Complete Seal Service Kit - 500 Series Filters
10B	RK33802	Replacement WIF Probe - 1/2"-20 UNF (Requires Water Detection Module Amplifier - <i>See RSL7529 Brochure</i>)
10C	RK30880E	WIF Sensor and Light Kit - 1/2"-20 UNF
10D	RK 20726	Water Detection Module Kit - 12 or 24 vdc - Includes Amplifier (Light and Buzzer) & RK 21069 (WIF Probe)
10E	RK 11861	Heater Relay Kit - 12 vdc
	RK 11862	Heater Relay Kit - 24 vdc

Turbine Series - 500MA/500MAM

FUEL

Specifications:

Height: MA - 10.82" (27.48 cm)
 MAM - 10.77" (27.36 cm)
Width: 4.15" (10.5 cm)
 with Bracket 6.5" (16.51 cm)
Depth: 4.15" (10.5 cm)
 with Bracket 5.17" (13.13 cm)
Weight: MA - 4.0 lbs (1.8 kg)
 MAM - 5.0 lbs (2.2 kg)
Ports: 3/4"-16 UNF (SAE J1926)
Service Clearance (Top): 4.0" (10.16 cm)
Vacuum Installation Recommended
Maximum Pressure: 15 psi (1.03 bar)
Max Flow Rate: 60 gph (227 lph)

Create a Part Number

Housing Type	Assembly Options	Filtration Rating
Turbine Model - Marine Standard 3/4"-16 Ports Clear Bowl/Heat Shield	Metal Bowl Option	2 micron 10 micron 30 micron
500MA	M	2 10 30

RACOR®

Dimensions:

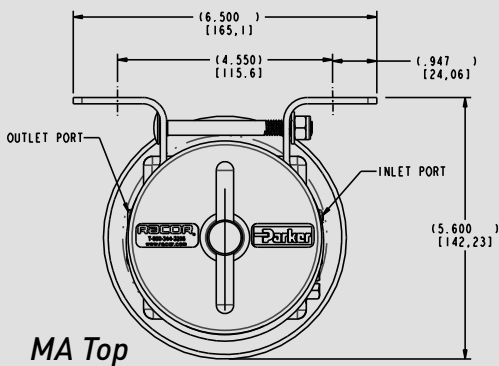

ASSEMBLY	DESCRIPTION
500MA2	Marine - 500 Turbine Assy., 2 micron Filter
500MA10	Marine - 500 Turbine Assy., 10 micron Filter
500MA30	Marine - 500 Turbine Assy., 30 micron Filter
500MAM2	Marine - Metal Bowl - 500 Turbine Assy., 2 micron Filter
500MAM10	Marine - Metal Bowl - 500 Turbine Assy., 10 micron Filter
500MAM30	Marine - Metal Bowl - 500 Turbine Assy., 30 micron Filter

SINGLE ASSEMBLY

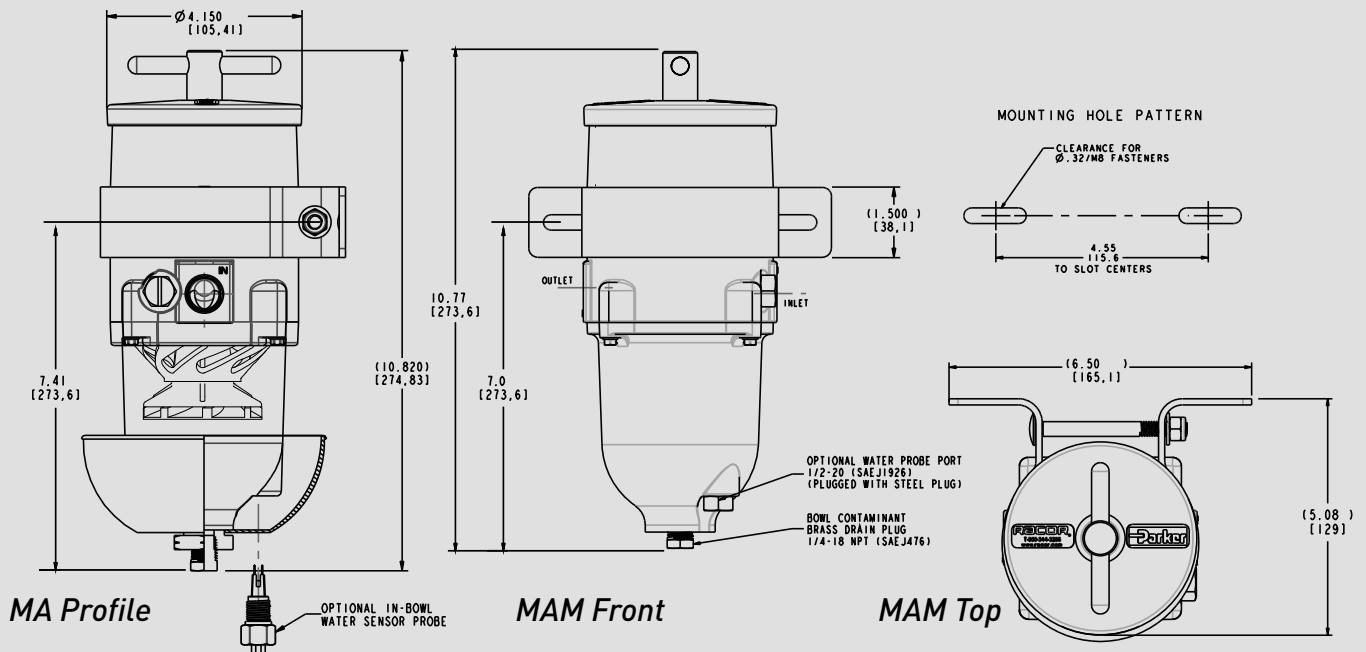

PARTS

Turbine - 500MA/500MAM

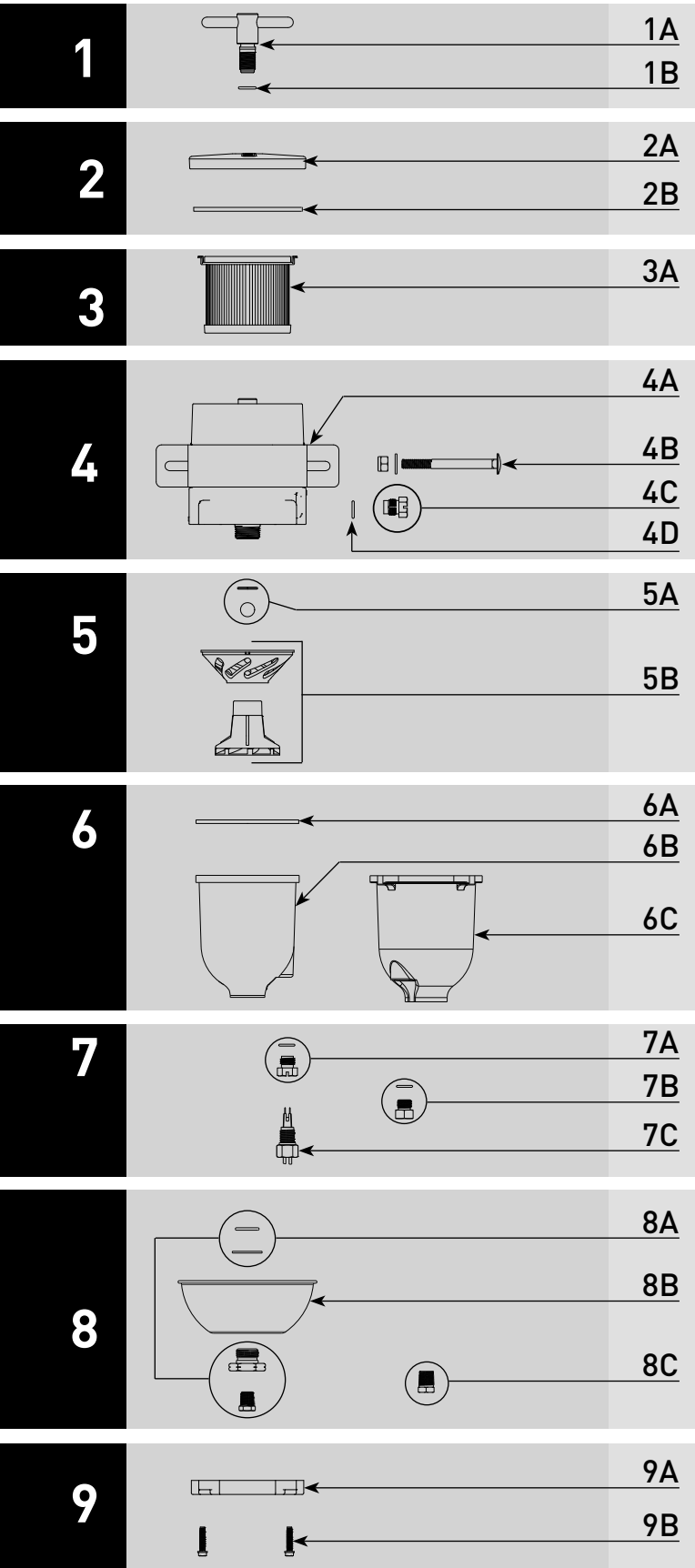

Part #		Description
1A	RK23183	T-handle Kit - Includes 1B
	RK19671	Optional - T-handle Vacuum Gauge Kit - For 500MA/MAM Assemblies Manufactured After 2002
1B		T-handle O-ring
2A	RK15078-02	500MA/MAM Lid Kit - Includes 1B and 2B
2B		Lid Gasket - Included in 10A
3A	2010SM-OR	Replacement Element 2 micron - Includes 1B and 2B
	2010TM-OR	Replacement Element 10 micron - Includes 1B and 2B
	2010PM-OR	Replacement Element 30 micron - Includes 1B and 2B
4A	RK15441-01	Clamp Bracket Kit - Includes (1) Bolt, (1) Washer, and (1) Nut
4B	RK 11838	Carriage Bolt Kit - Includes (2) Bolt, (2) Washer, and (2) Nut
4C	RK 11-1679	Feed-thru Plug Kit - Includes 4D
4D		Plug O-ring - Included in 10A
5A	RK 15010B	Checkball and Gasket Kit
5B	RK 15013D	Centrifuge and Baffle Kit - Includes 5A and 6A
6A		Bowl Gasket - Included in 10A
6B	RK 15279-01	Bowl Kit (Clear) - Includes 6A, 7A and 8A Seal/Gasket
6C	RK 15301-02	Bowl Kit (Metal) - Includes 6A, 7B, 8C and 9B
7A	RK 20126	Bowl Plug Kit (MA) - Nylon - 1/2"-20 UNF
7B	RK 20022	Bowl Plug Kit (MAM) - Metal - 1/2"-20 UNF
7C	RK 21069	WIF Probe Kit - 1/2"-20 UNF - 2-wire (MA) - Requires 10C
	RK23191	WIF Probe Kit (Stainless Steel) - 1/2"-20 UNF - 2-wire (MAM) - Requires 10C
8A	RK 11-1910	Drain Plug Kit (MA)
8B	RK 15104	Heat Deflector (MA) - Includes 8A
8C		Drain Plug (MAM) - Contact Technical Support
9A	RK 15035-01	Bowl Ring - (For MA Only - White) Includes 6A
9B	RK 15081	Bowl Fasteners (set of 4)
Accessories and Parts Available (Not Shown)		
10A	RK 15211	Complete Seal Service Kit - 500 Series Filters
10B	RK 14329	Water Detection Module - 12 vdc
	RK 14321	Water Detection Module - 24 vdc
10C	RK 19492	Shut-off Valve Drain Kit - UL Listed



Turbine Series - 900FH/1000FH

FUEL

Specifications:

Height: 900FH: 16.5" (41.9 cm)
 1000FH: 21.8" (55.4 cm)
Width: 5.96" (15.1 cm)
Depth: 5.96" (15.1 cm)
 with Bracket 6.32" (16.1 cm)
Weight: 900FH: 6.0 lbs (2.7 kg)
 1000FH: 10 lbs (4.5 kg)
Ports: 7/8"-14 UNF-2B (SAE J1926)
Service Clearance (Top): 900FH: 5.0" (12.7 cm)
 1000FH: 10.0" (25.4 cm)
Vacuum Installation Recommended
Maximum Pressure: 15 psi (1.03 bar)
Max Flow Rate: 900FH: 90 gph (341 lph)
 1000FH: 180 gph (681 lph)

Create a Part Number

Housing Type		Heater Option		Filtration Rating		
Turbine Model 90 GPH Flow Rate	Turbine Model 180 GPH Flow Rate	12 VDC Heater (325 watt)	24 VDC Heater (325 watt)	2 micron	10 micron	30 micron
900FH	1000FH	312	324	2	10	30

RACOR®

Dimensions:

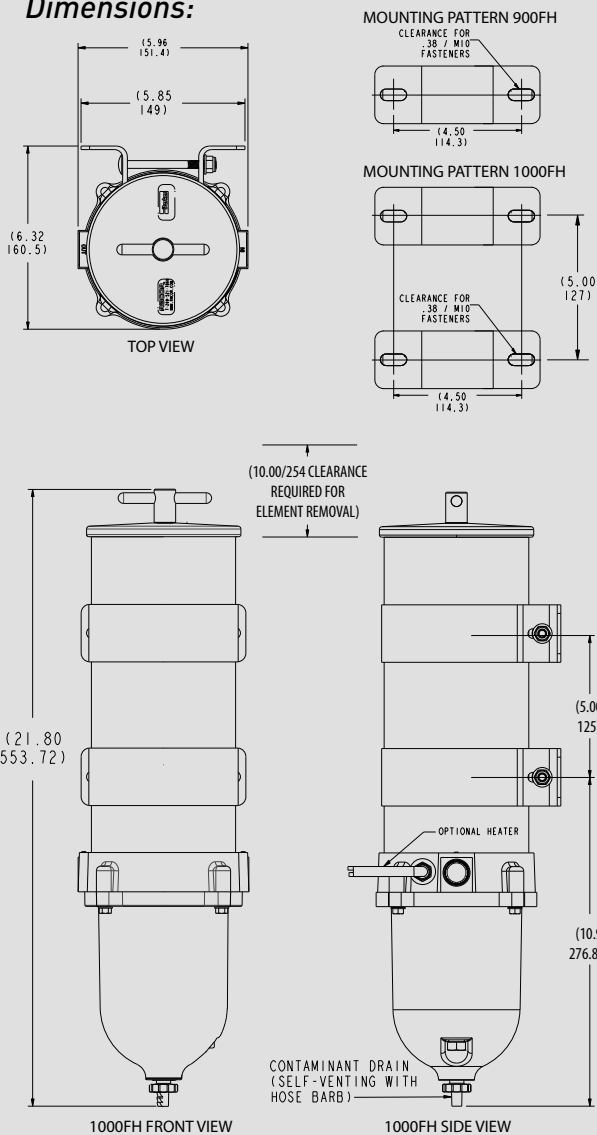

ASSEMBLY	DESCRIPTION
900FH2	900 Turbine Assy., 2 micron Filter
900FH10	900 Turbine Assy., 10 micron Filter
900FH30	900 Turbine Assy., 30 micron Filter
900FH31230	900 Turbine Assy., 12VDC Heater, 30 micron Filter
900FH32430	900 Turbine Assy., 24VDC Heater, 30 micron Filter
1000FH2	1000 Turbine Assy., 2 micron Filter
1000FH10	1000 Turbine Assy., 10 micron Filter
1000FH30	1000 Turbine Assy., 30 micron Filter
1000FH3122	1000 Turbine Assy., 12VDC Heater, 2 micron Filter
1000FH31210	1000 Turbine Assy., 12VDC Heater, 10 micron Filter
1000FH31230	1000 Turbine Assy., 12VDC Heater, 30 micron Filter
1000FH3242	1000 Turbine Assy., 24VDC Heater, 2 micron Filter
1000FH32430	1000 Turbine Assy., 24VDC Heater, 30 micron Filter

SINGLE ASSEMBLY



PARTS

Turbine - 900FH/1000FH

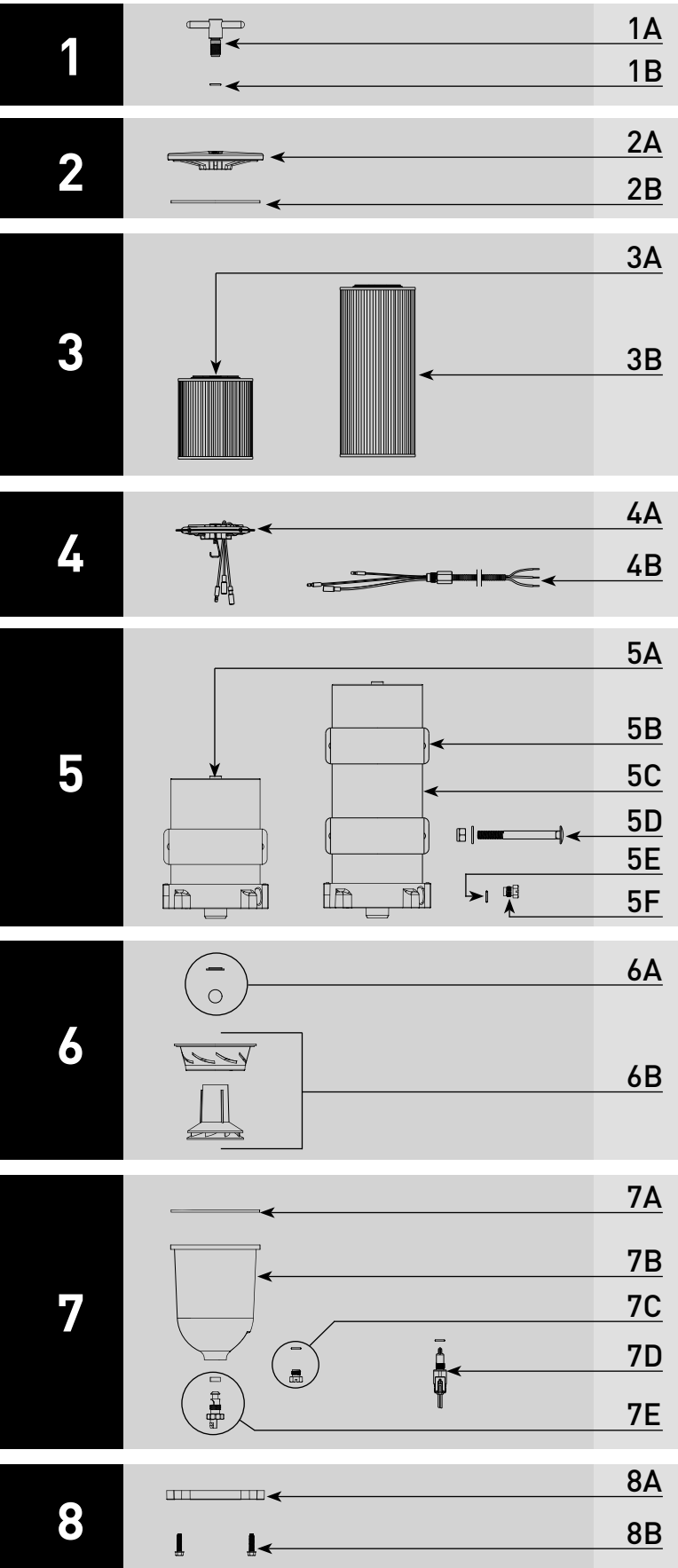

Part #		Description
1A	RK23183	T-handle Kit - Includes 1B & 2B
	RK19671	Optional - Stainless Steel T-handle Vacuum Gauge
1B		T-handle O-ring - Included in 9A
2A	RK 11-1927-01	900FH/1000FH Lid Kit - Includes 1B & 2B
2B		Lid Gasket - Included in 9A
3A	2040N-02	900FH Replacement Element 2 micron - Includes 1B & 2B
	2040N-10	900FH Replacement Element 10 micron - Includes 1B & 2B
	2040N-30	900FH Replacement Element 30 micron - Includes 1B & 2B
3B	2020N-02	1000FH Replacement Element 2 micron - Includes 1B & 2B
	2020N-10	1000FH Replacement Element 10 micron - Includes 1B & 2B
	2020N-30	1000FH Replacement Element 30 micron - Includes 1B & 2B
4A	RK11-2016	Heater Kit - 12 vdc, 325 watt - Includes 1B, 2B & 4B
	RK11-2015	Heater Kit - 24 vdc, 325 watt - Includes 1B, 2B & 4B
4B		3-wire Heater Feed-thru - Included in 4A
5A	RK11-2009	900FH Body/Housing/Return Tube - Includes 2B, 7A & 8B
5B	RK11-2005	Bracket Kit - Includes Bolt, Washer, and Nut
5C	RK11-2010	1000FH Body/Housing/Return Tube - Includes 2B, 7A & 8B
5D	RK 11838	Carriage Bolt Kit - Includes (2) Bolt, (2) Washer, and (2) Nuts
5E		Heater Feed-thru or Plug O-ring - Included in 9A
5F	RK 11-1679	Feed-thru Plug - Includes 5E
6A	RK 11028B	Checkball and Gasket Kit - Included in 9A
6B	RK 11-1939	Centrifuge and Baffle Kit - Includes 6A & 7A
7A		Bowl Gasket - Included in 9A
7B	RK 11-1938	Bowl Kit - Includes 7A, 7C & 7E
7C	RK 20126	Bowl Plug (O-ring Included in 9A)
7D	RK33802	WIF Probe Kit - 1/2"-20 UNF - Two Wire Pigtail Water Detection Module Required - Use 9C
7E		Self-venting Drain (Gasket Included in 9A)
8A	RK 11037A	Bowl Ring Kit (FH - Tan) - Includes 7A & 8B
8B	RK 11542	Cap Screw Bowl Fasteners (set of 4)

Accessories and Parts Available - *Not Shown*

9A	RK 11-1952	Complete Seal Service Kit - 900FH/1000FH Series Filters
9B	RK19669	Vacuum Gauge (30" Hg) - 3 needles: Theshold (red), Max Change Out (Red - Adjustable), Gauge (Black)
	RK19667	Compound Gauge - pressure (15 PSI) and vacuum (30" Hg)
9C	RK 14329	Water Detection Module - 12 vdc
	RK 14321	Water Detection Module - 24 vdc
9D	RK30880E	WIF Sensor/Detection Kit - 1/2"-20 UNF
9E	RK11-1978	Checkball Spring Kit
9F	RKP1912	Primer Pump Kit - 12 vdc - <i>Adds 3.25" (8.26 cm) to Height</i>
	RKP1924	Primer Pump Kit - 24 vdc - <i>Adds 3.25" (8.26 cm) to Height</i>

Turbine Series - 900/1000MA-MAM

FUEL

Specifications:

Height: 900MA: 16.2" (41.9 cm) MAM: 15.9" (41.9 cm)
1000MA: 22.0" (55.4 cm) MAM: 21.8" (55.4 cm)

Width: 5.96" (15.1 cm)

Depth: 5.96" (15.1 cm)
with Bracket 6.32" (16.1 cm)

Weight: 900MA: 6.0 lbs (2.7 kg) MAM: 7.0 lbs (3.2 kg)
1000MA: 10 lbs (4.5 kg) MAM: 11 lbs (5.0 kg)

Ports: 7/8"-14 UNF-2B (SAE J1926)

Service Clearance (Top): 900MA: 5.0" (12.7 cm)
1000MA: 10.0" (25.4 cm)

Vacuum Installation Recommended

Maximum Pressure: 15 psi (1.03 bar)

Max Flow Rate: 900MA/M: 90 gph (341 lph)
1000MA/M: 180 gph (681 lph)

Create a Part Number

Housing Type	Turbine Model - Marine 90 GPH (341 LPH) Clear Bowl/Heat Shield		Turbine Model - Marine 180 GPH (681 LPH) Clear Bowl/Heat Shield		Assembly Options	Metal Bowl Option	Probe - WIF Probe	Filtration Rating
	900MA	1000MA	900MA	1000MA				
						M		2 micron
							P	10 micron
								30 micron
								2
								10
								30
								2
								10
								30

Dimensions:

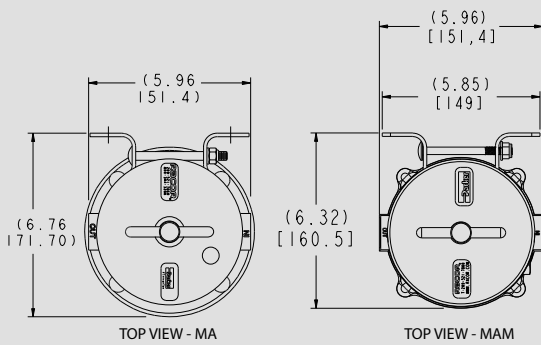

ASSEMBLY	DESCRIPTION
900MA2	900 Marine Turbine Assy., 2 micron Filter
900MA10	900 Marine Turbine Assy., 10 micron Filter
900MA30	900 Marine Turbine Assy., 30 micron Filter
900MAM2	900 Marine - Metal Bowl - Turbine Assy., 2 micron Filter
900MAM10	900 Marine - Metal Bowl - Turbine Assy., 10 micron Filter
900MAM30	900 Marine - Metal Bowl - Turbine Assy., 30 micron Filter
1000MA2	1000 Marine Turbine Assy., 2 micron Filter
1000MA10	1000 Marine Turbine Assy., 10 micron Filter
1000MA30	1000 Marine Turbine Assy., 30 micron Filter
1000MAM2	1000 Marine - Metal Bowl - Turbine Assy., 2 micron Filter
1000MAM10	1000 Marine - Metal Bowl - Turbine Assy., 10 micron Filter
1000MAM30	1000 Marine - Metal Bowl - Turbine Assy., 30 micron Filter
1000MAP10	1000 Marine - Water Probe - Turbine Assy., 10 micron Filter

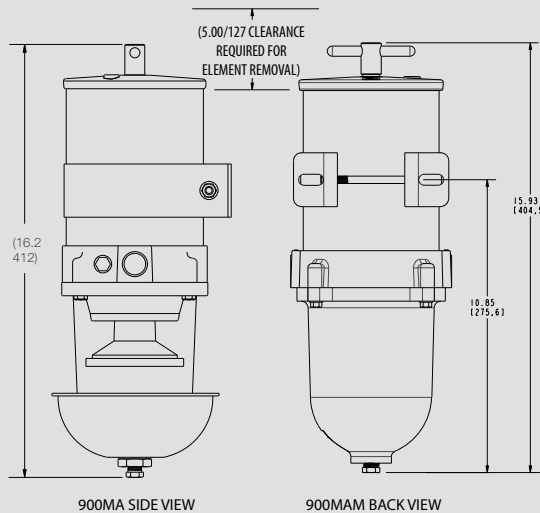
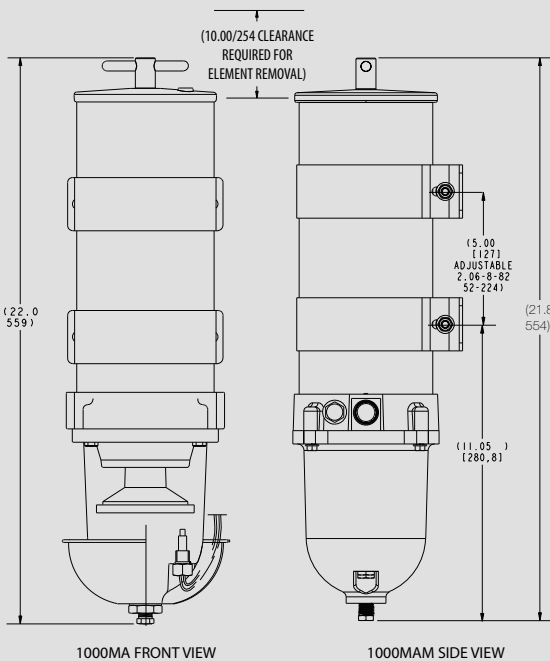

MOUNTING PATTERN 900MA/MAM

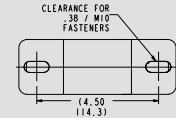

MOUNTING PATTERN 1000MA/MAM

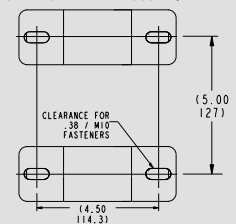

PARTS

Turbine - 900/1000MA-MAM

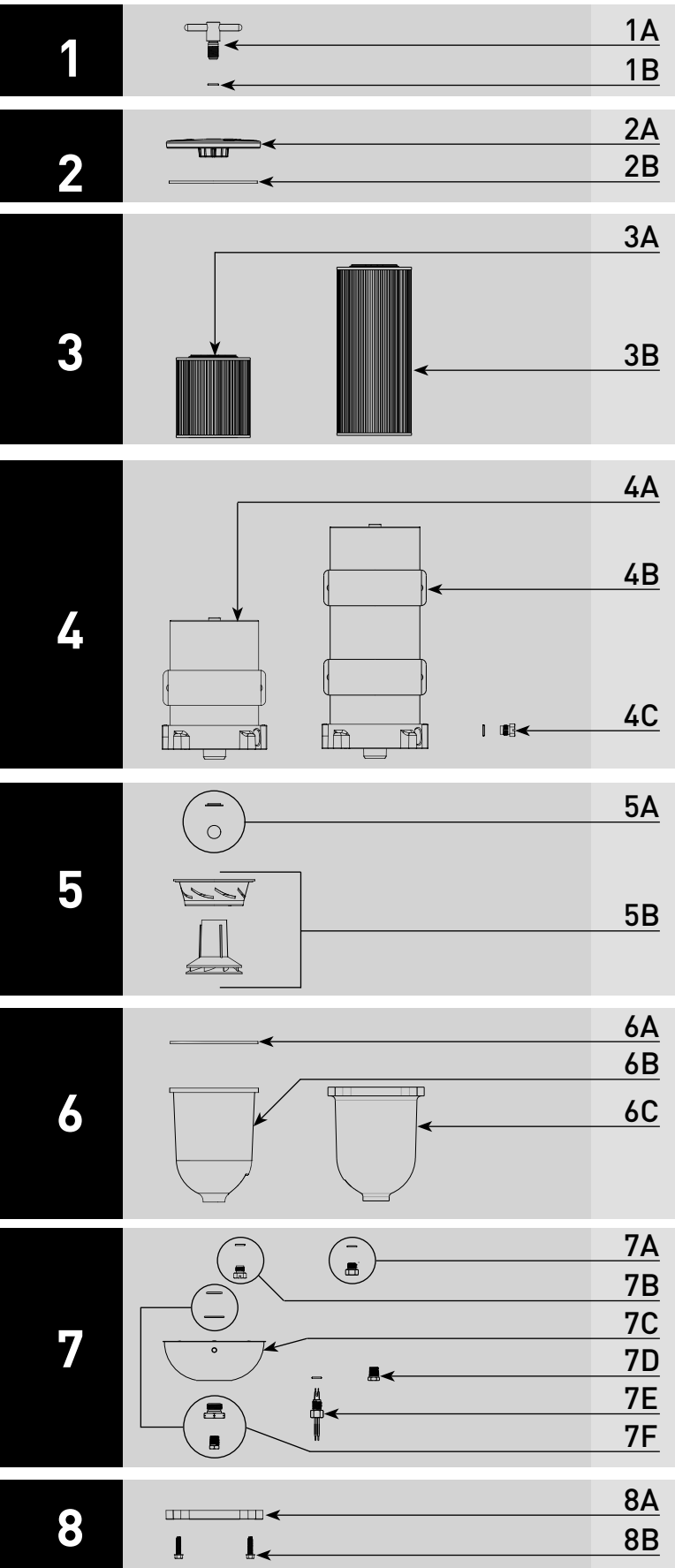

Part #		Description
1A	RK23183	Stainless Steel T-handle Kit - Includes 1B Optional - Stainless Steel T-handle Vacuum Gauge
	RK19671	
1B		T-handle O-ring - Included in 9A
2A	RK 11-1933-04	900/1000MA-MAM Lid Kit - Includes 1B & 2B
2B		Lid Gasket - Included in 9A
3A	2040N-02	900MA/MAM Replacement Element 2 micron - Includes 1B & 2B
	2040N-10	900MA/MAM Replacement Element 10 micron - Includes 1B & 2B
	2040N-30	900MA/MAM Replacement Element 30 micron - Includes 1B & 2B
3B	2020N-02	1000MA/MAM Replacement Element 2 micron - Includes 1B & 2B
	2020N-10	1000MA/MAM Replacement Element 10 micron - Includes 1B & 2B
	2020N-30	1000MA/MAM Replacement Element 30 micron - Includes 1B & 2B
4A		900/1000MA-MAM Body/Housing - Not Sold Separately
4B	RK11-2005	Bracket Kit - (Black) Includes Bolt, Washer, and Nut
4C	RK 11-1679	Plastic Feed-thru Plug Kit (O-ring Included in 9A)
		Metal Feed-thru Plug - Contact Technical Support
5A	RK 11028B	Checkball and Gasket Kit (Gasket Included in 9A)
5B	RK 11-1939	Centrifuge and Baffle Kit - Includes 5A & 6A
6A		Bowl Gasket - Included in 9A
6B	RK 11-1606-1	MA Bowl Kit (Clear) - Includes 6A, 7B & 7F (Gasket & O-ring only)
6C	RK 11734-03	MAM Bowl Kit (Metal) - Includes 6A, 7A, 7D and 8B
7A	RK 20022	Metal Bowl Plug Kit (MAM) (O-ring Included in 9A)
7B	RK 20126	Plastic Bowl Plug Kit (MA) (O-ring Included in 9A)
7C	RK 11868	Heat Deflector Kit (MA) - Includes 7F
7D		Drain Plug (MAM) - Contact Technical Support
7E	RK 21069	WIF Probe - 1/2"-20 UNF - 2-wire (MA) - Requires 9C WIF Probe - Stainless Steel - 1/2"-20 UNF - 2-wire (MAM) - Requires 9C
	RK23191	
7F	RK 11-1910	Drain Plug Kit (MA) (Gasket & O-ring Included in 9A)
8A	RK 11037A-01	Bowl Ring Kit (For MA Only - White) - Includes 6A & 8B
8B	RK 11542	Cap Screw Bowl Ring Fasteners (set of 4)

Accessories and Parts Available - *Not Shown*

9A	RK 11-1404	Complete Seal Service Kit - 900/1000 Series Filters
9B	RK19669	Vacuum Gauge (30" Hg) - 3 needles: Theshold (red), Max Change Out (Red - Adjustable), Gauge (Black) Compound Gauge - pressure (15 PSI) and vacuum (30" Hg)
	RK19667	
9C	RK 14329	Water Detection Module - 12 vdc Water Detection Module - 24 vdc
	RK 14321	
9D	RK11-1978	Checkball Spring Kit
9E	RKP1912	Primer Pump Kit - 12 vdc - Adds 3.25" (8.26 cm) to Height Primer Pump Kit - 24 vdc - Adds 3.25" (8.26 cm) to Height
	RKP1924	

Model
MA



Model
MAM



Turbine Series - 75500FGX

FUEL

Specifications:

Height: 11.45" (29.08 cm)
Width: 14.5" (36.8 cm) with Bracket
Depth: 10.03" (25.5 cm) with Bracket
Weight: 17.0 lbs (7.7 kg)
Valve Ports: 3/4"-16 UNF
 (SAE J1926 O-ring Boss)
Service Clearance (Top): 4.0" (10.16 cm)
Vacuum Installation Recommended
Maximum Pressure: 15 psi (1.03 bar)
Max Flow Rate: 120 gph (454 lph)

Create a Part Number

Housing Type	Dual Assembly	75
Filtration Rating	Turbine Model 60/120 GPH Flow Rate	500FG
Valve Type	6-Port Ball Valve	X
Filtration Rating	2 micron 10 micron 30 micron	2 10 30

RACOR®

Dimensions:

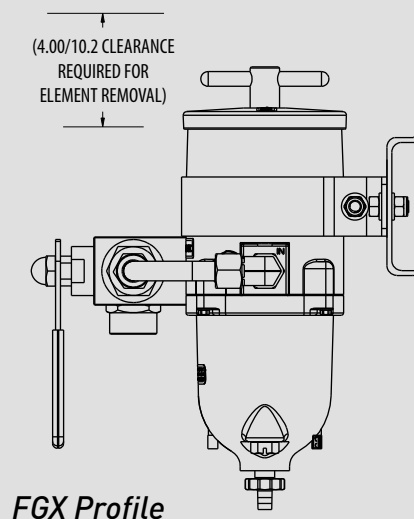
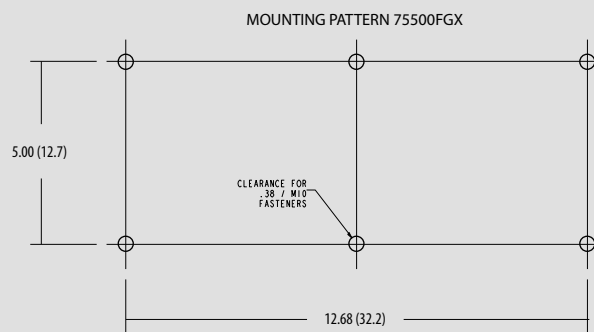
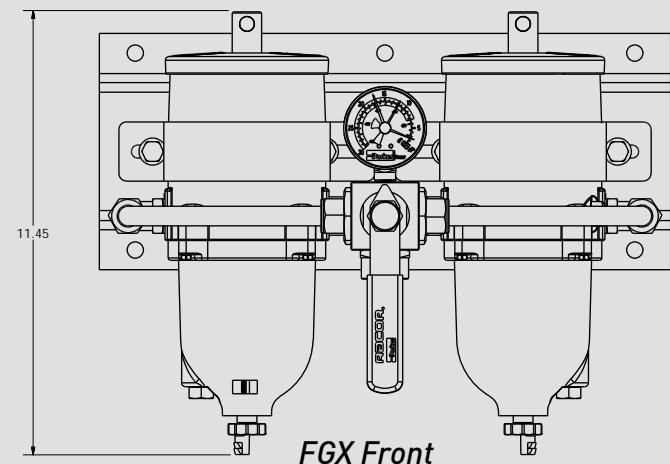
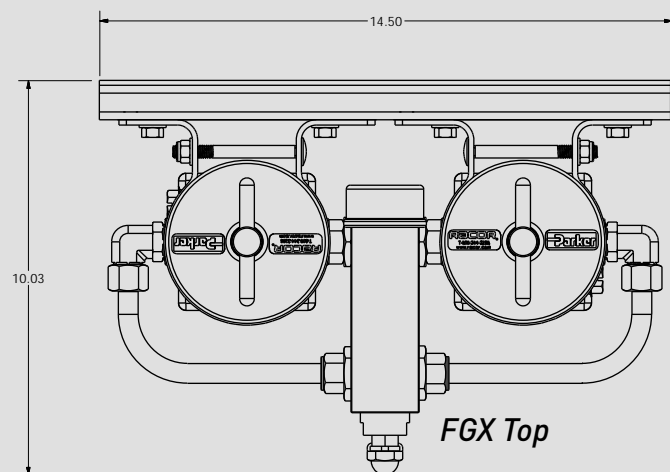

ASSEMBLY	DESCRIPTION
75500FGX2	Dual 500 Turbine Assy., 2 micron Filter
75500FGX10	Dual 500 Turbine Assy., 10 micron Filter
75500FGX30	Dual 500 Turbine Assy., 30 micron Filter

DUAL ASSEMBLIES



PARTS

Turbine Series - 75500FGX

1

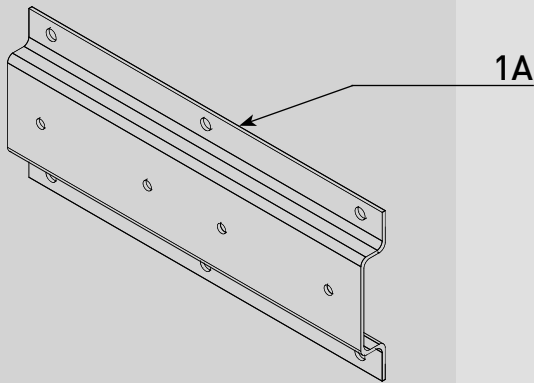

1A

2



2A

3

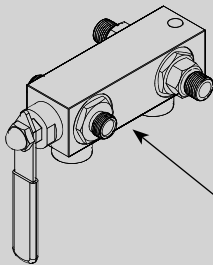

3A

4

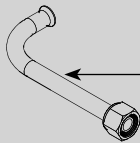

4A

5

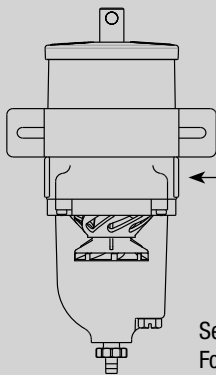

5A

See RSL0288
For Complete 500FG
Parts Breakdown

Part #	Description
1A	Mounting Bracket - Bracket only
2A RK19669 RK19667	Vacuum Gauge (30" Hg) - 3 needles: Theshold (red), Max Change Out (Red - Adjustable), Gauge (Black) <i>Optional</i> - Compound Gauge Kit (Vacuum 30" HG / Pressure 15psi)
3A RK 15390 RK 15419	6-Port Ball Valve - 1.5 in. Body Valve Rebuild Kit - For 2.0 in. Valve Body Only
4A RK 15391	Rigid Tubing Kit - Includes (1ea.) Tube, Ferrule and Fitting
5A	Turbine Fuel Filter - 500FG Series See Cutsheet RSL0288 for available Parts and Accessories

Accessories and Parts Available (Not Shown)

6A	RK 15211	Complete Seal Service Kit - 500 Series Filters (<i>Requires 2</i>)
6B	RK33802	WIF Probe Kit - 1/2"-20 UNF - Requires 6D
6C	RK30880E	WIF Sensor and Light Kit - 1/2"-20 UNF
6D	RK 14329 RK 14321	Water Detection Module - 12 vdc Water Detection Module - 24 vdc
7A	2010SM-OR 2010TM-OR 2010PM-OR	Replacement Element 2 micron Replacement Element 10 micron Replacement Element 30 micron
8A		Bowl Gasket - Included in 6A
8B	RK15405	Bowl Kit (2002 to Present) - Includes 8A, 9A and 9B **Bowl has 5/8"-11 drain port
8C	RK 15279-01	Bowl Kit (Before 2002) - Includes 8A and 9B **Bowl has 7/8"-14 drain port
9A		Self-venting Drain Kit (<i>2002 to Present - Use with 8B</i>)
9B	RK 20126	Bowl Plug Kit
9C	RK 30488	Self-venting Drain Kit (<i>Before 2002 - Use with 8C</i>)

Valve Operations

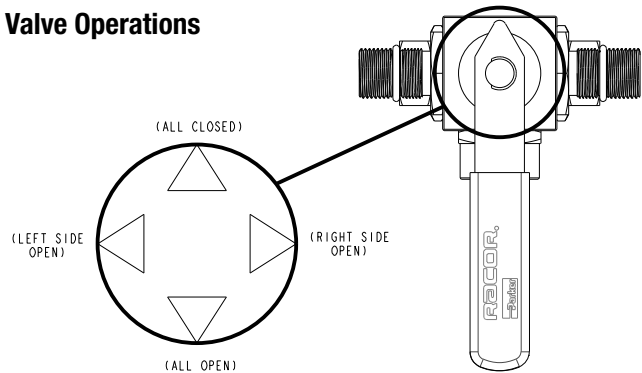

Turbine Series - 75500MAX-MAXM

FUEL

Specifications:

Height: MAX/MAXP 11.5" (29.21 cm)
MAXM 10.58" (29.08 cm)

Width: 14.5" (36.8 cm) with Bracket

Depth: 9.88" (25.1 cm) with Bracket

Weight: 17.0 lbs (7.7 kg)

Ports: 3/4"-16 UNF-2B
(SAE J1926 O-ring Boss)

Service Clearance (Top): 4.0" (10.16 cm)

Vacuum Installation Recommended
Maximum Pressure: 15 psi (1.03 bar)

Max Flow Rate: 120 gph (454 lph)

Create a Part Number

Housing Type	Dual Assembly	75
Filtration Model	Turbine Model 60/120 GPH Flow Rate	500MA
Valve Type	6 Port Valve	X
Assembly Options	Metal Bowl Option WIF Probe Option	M P
Filtration Rating	2 micron 10 micron 30 micron	2 10 30

RACOR®

Dimensions:

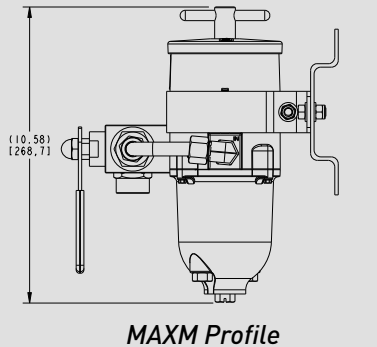
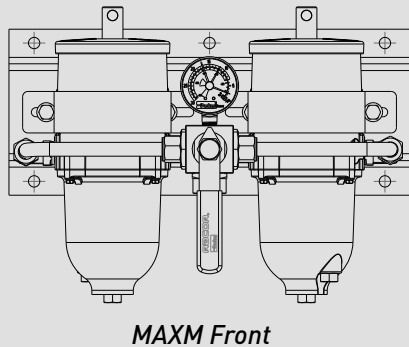
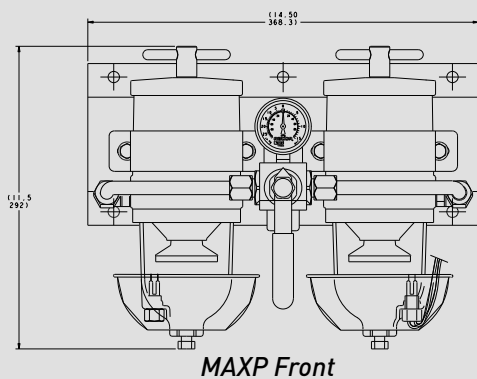
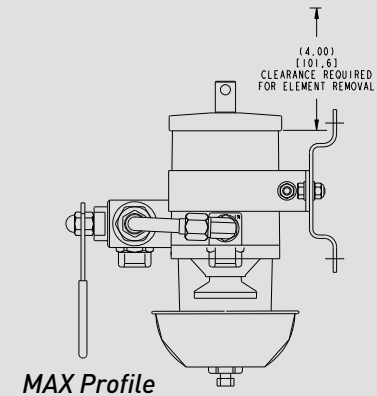
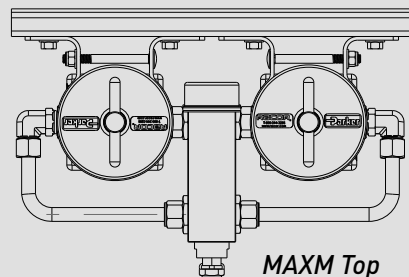
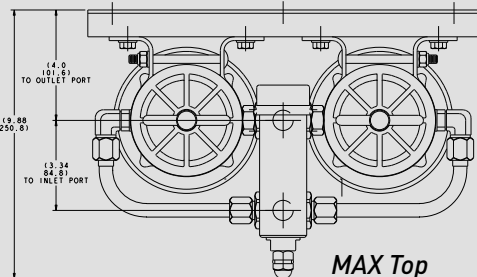
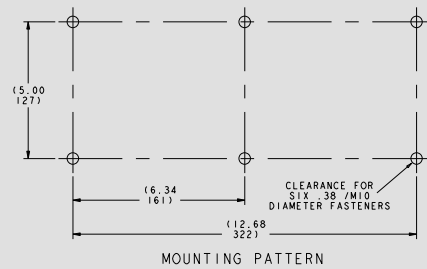

ASSEMBLY	DESCRIPTION
75500MAX2	Marine - Dual 500 Turbine Assy., 2 micron Filter
75500MAX10	Marine - Dual 500 Turbine Assy., 10 micron Filter
75500MAX30	Marine - Dual 500 Turbine Assy., 30 micron Filter
75500MAXM2	Marine - Metal Bowl - Dual 500 Turbine Assy., 2 micron Filter
75500MAXM10	Marine - Metal Bowl - Dual 500 Turbine Assy., 10 micron Filter
75500MAXM30	Marine - Metal Bowl - Dual 500 Turbine Assy., 30 micron Filter
75500MAXP30	Marine - Dual 500 Turbine Assy., Water Sensor Probe, 30 micron Filter

DUAL ASSEMBLIES



PARTS

Turbine Series - 75500MAX-MAXM

1

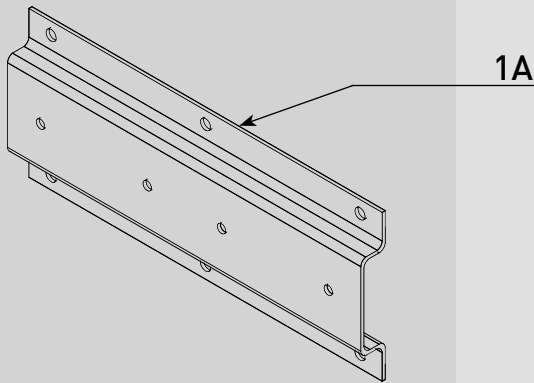

1A

2



2A

3

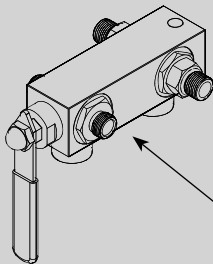

3A

4

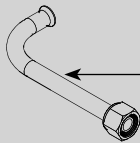

4A

5

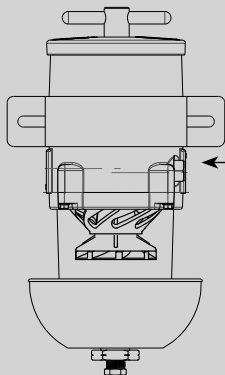

5A

See RSL0289
For 500MA/MAM
Parts Breakdown

Part #	Description
1A	Mounting Bracket - Bracket only (Tan)
2A	RK19669 Vacuum Gauge (30" Hg) - 3 needles: Theshold (red), Max Change Out (Red - Adjustable), Gauge (Black) RK19667 <i>Optional</i> - Compound Gauge Kit (Vacuum 30" HG / Pressure 15psi)
3A	RK 15390 6-Port Ball Valve - 1.5 in. Body RK 15419 Valve Rebuild Kit - For 2.0 in. Valve Body Only
4A	RK 15391 Rigid Tubing Kit - Includes (1ea.) Tube, Ferrule and Fitting
5A	Turbine Fuel Filter - 500MA/MAM Series See Cutsheet RSL0289 for available Parts and Accessories

Accessories and Parts Available (Not Shown)

6A	RK 15211	Complete Seal Service Kit - 500 Series Filters (<i>Requires 2</i>)
6B	RK 21069	WIF Probe Kit - 1/2"-20 UNF - 2-wire (MA) - Requires 6C
	RK23191	WIF Probe Kit (Stainless Steel) - 1/2"-20 UNF - 2-wire (MAM) - Requires 6C
6C	RK 14329	Water Detection Module - 12 vdc
	RK 14321	Water Detection Module - 24 vdc
7A		Bowl Gasket - Included in 6A
7B	RK 15279-01	Bowl Kit (Clear) - Includes 7A, 8A and Drain Seal/Gasket
7C	RK 15301-02	Bowl Kit (Metal) - Includes 7A, 8B, 9C and 10B
8A	RK 20126	Bowl Plug Kit (MA) - Nylon - 1/2"-20 UNF
8B	RK 20022	Bowl Plug Kit (MAM) - Metal - 1/2"-20 UNF
9A	RK 11-1910	Drain Plug Kit (MA)
9B	RK 15104	Heat Deflector (MA) - Includes 9A
9C		Drain Plug (MAM) - <i>Contact Technical Support</i>
10A	RK 15035-01	Bowl Ring - (For MA Only - White) Includes 7A
10B	RK 15081	Bowl Fasteners (set of 4)
11A	2010SM-OR	Replacement Element 2 micron
	2010TM-OR	Replacement Element 10 micron
	2010PM-OR	Replacement Element 30 micron

Valve Operations

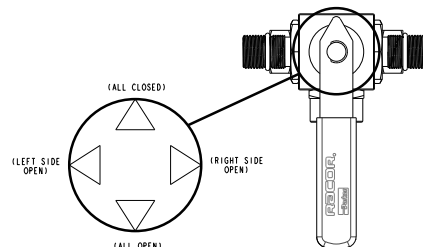

Turbine Series - 75900/1000FHX

FUEL

Specifications:

Height: 75900FHX: 16.5" (41.9 cm)
751000FHX: 21.8" (55.4 cm)

Width: 18.75" (47.6 cm) with Bracket

Depth: 10.8" (27.4 cm) with Bracket

Weight: 75900FHX: 23.0 lbs (10.4 kg)
751000FHX: 30 lbs (13.6 kg)

Valve Male Fittings:
7/8"-14 UNF-2A (SAE J514 37° Flare)

Service Clearance (Top):
75900FHX: 5.0" (12.7 cm)
751000FHX: 10.0" (25.4 cm)

Vacuum Installation Recommended
Maximum Pressure: 15 psi (1.03 bar)

Max Flow Rate:
75900FHX: 180 gph (682 lph)
751000FHX: 360 gph (1362 lph)

Create a Part Number

Housing Type	Filter Model	Valve Type	Filtration Rating
Dual Assembly	Turbine Model 90/180 GPH Flow Rate	6-Port Ball Valve	2 micron
75	Turbine Model 180/360 GPH Flow Rate	X	10 micron
	900FH 1000FH		30 micron

RACOR®

Dimensions:

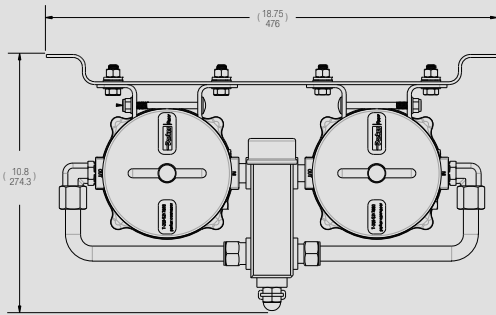

75900FHX/751000FHX Top

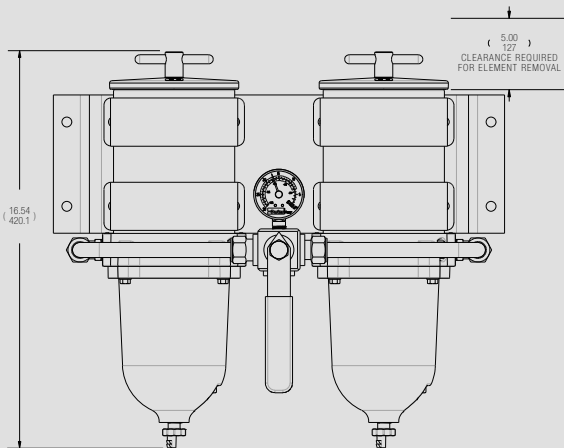

75900FHX Front

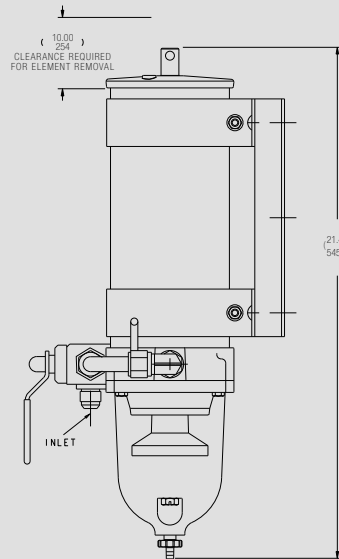

751000FHX Profile

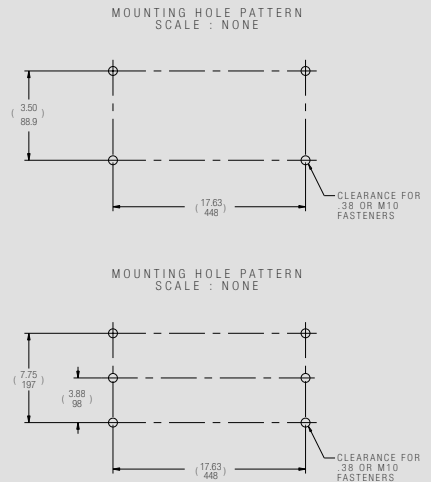

ASSEMBLY	DESCRIPTION
75900FHX2	Dual 900 Turbine Assy., 2 micron Filter
75900FHX10	Dual 900 Turbine Assy., 10 micron Filter
75900FHX30	Dual 900 Turbine Assy., 30 micron Filter
751000FHX2	Dual 1000 Turbine Assy., 2 micron Filter
751000FHX10	Dual 1000 Turbine Assy., 10 micron Filter
751000FHX30	Dual 1000 Turbine Assy., 30 micron Filter

DUAL ASSEMBLIES



PARTS

Turbine Series - 75900/1000FHX

1

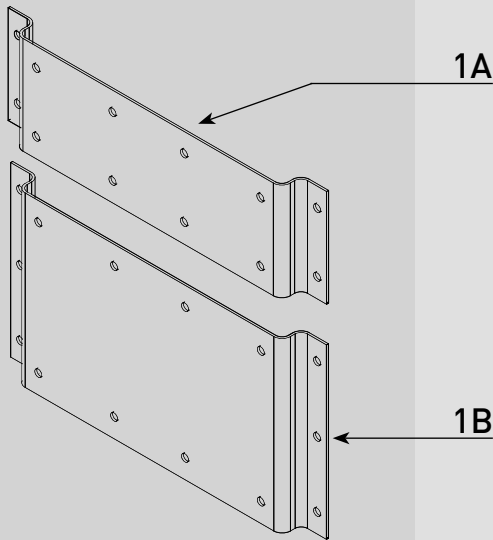

2



3

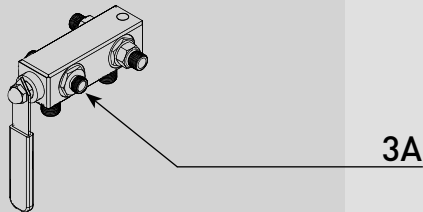

4

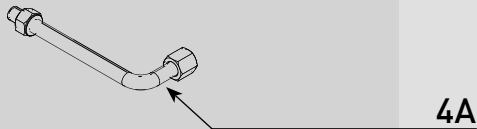

5

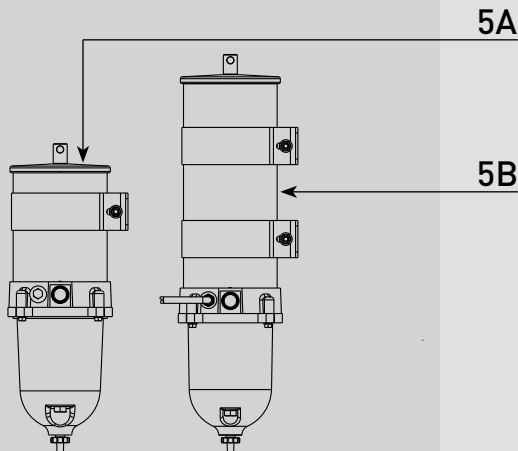

See **RSL0292**
For 900FH/1000FH Parts Breakdown

Part #	Description
1A	RK 19486 Mounting Bracket - 75900FHX - Bracket only
1B	RK 11-1777 Mounting Bracket - 751000FHX - Bracket only
2A	RK19669 Vacuum Gauge (30" Hg) - 3 needles: Theshold (red), Max Change Out (Red - Adjustable), Gauge (Black) RK19667 <i>Optional</i> - Compound Gauge Kit (Vacuum 30" HG / Pressure 15psi)
3A	RK 19473 6-Port Ball Valve
4A	RK 19475 Rigid Tubing Kit - Includes (1ea.) Tube, Ferrule and Fitting
5A	Turbine Fuel Filter - 900FH Series See Cutsheet RSL0292 for available Parts and Accessories
5B	Turbine Fuel Filter - 1000FH Series See Cutsheet RSL0292 for available Parts and Accessories

Accessories and Parts Available (Not Shown)

6A	RK 11-1952 Complete Seal Service Kit - 900FH/1000FH Series Filters (Requires 2) RK 11-1404 Complete Seal Service Kit - 900/1000 Series Filters For FG and Older Models (Requires 2)
6B	RK30880E WIF Sensor and Light Kit - 1/2"-20 UNF
6C	RK 14329 Water Detection Module - 12 vdc RK 14321 Water Detection Module - 24 vdc
6D	RK 19506 Valve Service Kit - Includes Handle/Stem/O-rings/Gasket
7A	Bowl Gasket - Included in 6A
7B	RK 11-1938 Bowl Kit - Includes 7A, 7C & 7E
7C	RK 20126 Bowl Plug (O-ring Included in 6A)
7D	RK33802 WIF Probe Kit - 1/2"-20 UNF - Two Wire Pigtail Water Detection Module Required - Use 6C
7E	Self-venting Drain (O-ring Included in 6A)
8A	2040N-02 900FH Replacement Element 2 micron 2040N-10 900FH Replacement Element 10 micron 2040N-30 900FH Replacement Element 30 micron
8B	2020N-02 1000FH Replacement Element 2 micron 2020N-10 1000FH Replacement Element 10 micron 2020N-30 1000FH Replacement Element 30 micron

Valve Operations

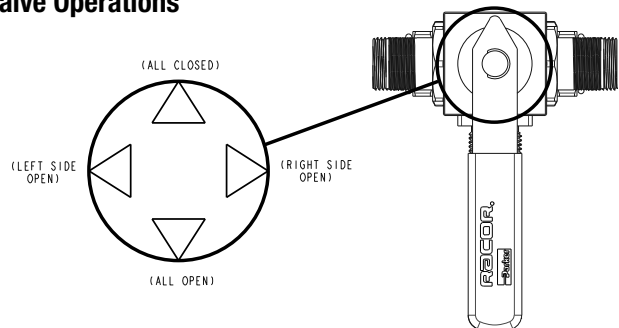

Turbine Series - 75900/1000MAX/M/P

FUEL

Specifications:

Height: 75900MAX: 16.5" (41.9 cm)
 751000MAX: 22.0" (55.9 cm)
 75900MAXM: 15.8" (40.1 cm)
 751000MAXM: 21.8" (55.4 cm)

Width: 18.75" (47.6 cm) with Bracket

Depth: 10.8" (27.4 cm) with Bracket

Weight: 75900MAX: 23.0 lbs (10.4 kg)
 751000MAX: 30 lbs (13.6 kg)
 75900MAXM: 23.0 lbs (10.4 kg)
 751000MAXM: 30 lbs (13.6 kg)

Valve Male Fittings:
 7/8"-14 UNF-2A
 (SAE J514 37° Flare)

Service Clearance (Top):
 75900MAX: 5.0" (12.7 cm)
 751000MAX: 10.0" (25.4 cm)

Vacuum Installation Recommended
Maximum Pressure: 15 psi (1.03 bar)

Max Flow Rate:
 75900MAX: 180 gph (682 lph)
 751000MAX: 360 gph (1362 lph)

Create a Part Number

Housing Type	Filter Model	Valve Type	Assembly Options	Filtration Rating
Dual Assembly	Turbine Model 90/180 GPH Flow Rate	6-Port Ball Valve	Metal Bowl Option WIF Probe Option	2 micron 10 micron 30 micron
75	900MA 1000MA	X	M P	2 10 30

ASSEMBLY	DESCRIPTION
75900MAX2	Marine - Dual 900 Turbine Assy., 2 micron Filter
75900MAX10	Marine - Dual 900 Turbine Assy., 10 micron Filter
75900MAX30	Marine - Dual Turbine Assy., 30 micron Filter
751000MAX2	Marine - Dual 1000 Turbine Assy., 2 micron Filter
751000MAX10	Marine - Dual 1000 Turbine Assy., 10 micron Filter
751000MAX30	Marine - Dual 1000 Turbine Assy., 30 micron Filter
75900MAXM2	Marine - Metal Bowl - Dual 900 Turbine Assy., 2 micron Filter
75900MAXM10	Marine - Metal Bowl - Dual 900 Turbine Assy., 10 micron Filter
75900MAXM30	Marine - Metal Bowl - Dual 900 Turbine Assy., 30 micron Filter
751000MAXM2	Marine - Metal Bowl - Dual 1000 Turbine Assy., 2 micron Filter
751000MAXM10	Marine - Metal Bowl - Dual 1000 Turbine Assy., 10 micron Filter
751000MAXM30	Marine - Metal Bowl - Dual 1000 Turbine Assy., 30 micron Filter
75900MAXP30	Marine - Dual 900 Turbine Assy., Water Sensor Probe, 30 micron Filter
751000MAXP10	Marine - Dual 1000 Turbine Assy., Water Sensor Probe, 10 micron Filter

Dimensions:

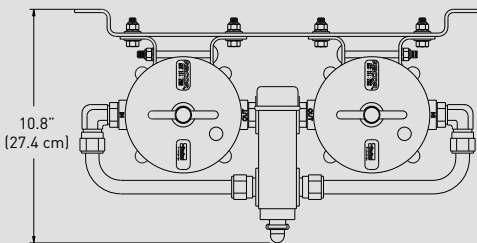

75900MAX/751000MAX Top

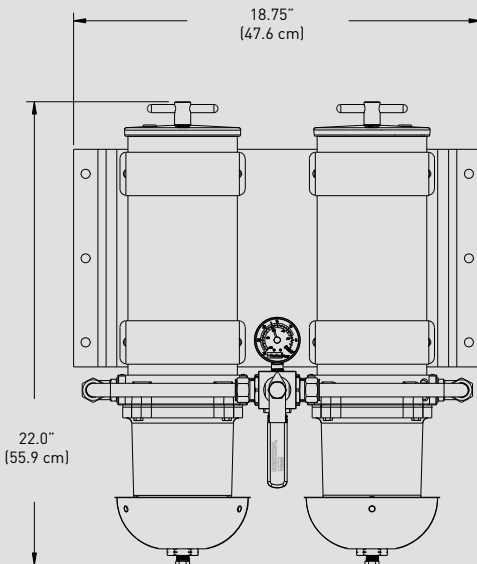

751000MAX Front

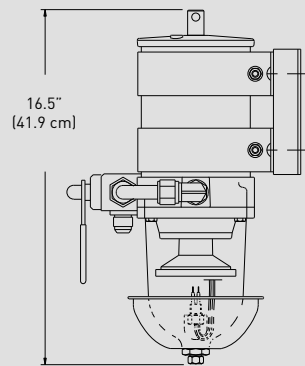

75900MAXP Profile

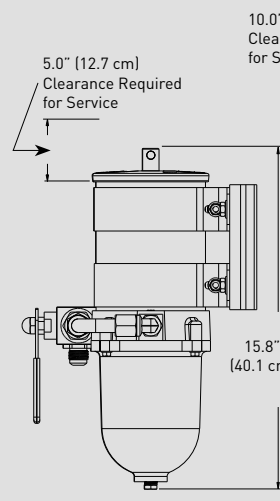

75900MAXM Profile

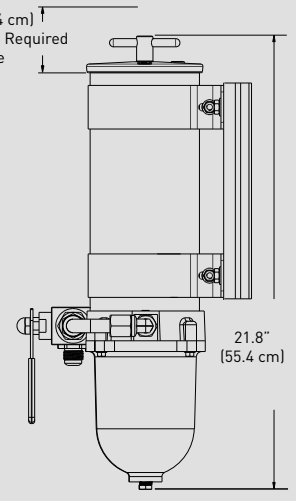

751000MAXM Profile



RACOR®

DUAL ASSEMBLIES

PARTS

Turbine Series - 75900/1000MAX/M/P

1

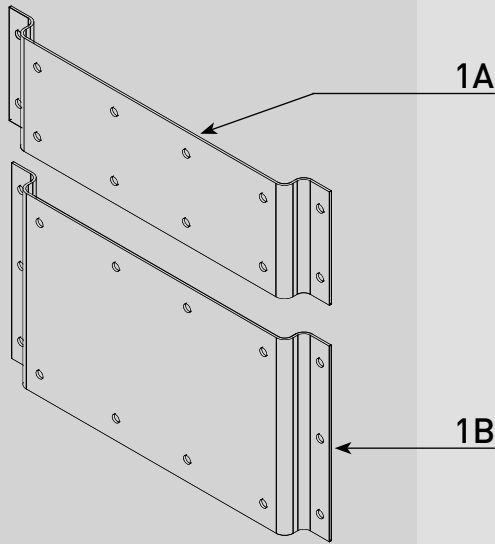

Part #	Description
1A RK 19486	Mounting Bracket - 75900MAX - Bracket only (Beige Color)
1B RK 11-1777	Mounting Bracket - 751000MAX - Bracket only (Beige Color)
2A RK19669 RK19667	Vacuum Gauge (30" Hg) - 3 needles: Theshold (red), Max Change Out (Red - Adjustable), Gauge (Black) <i>Optional</i> - Compound Gauge Kit (Vacuum 30" HG / Pressure 15psi)
3A RK 19473	6-Port Ball Valve
4A RK 19475	Rigid Tubing Kit - Includes (1ea.) Tube, Ferrule and Fitting
5A	Turbine Fuel Filter - 900MA Series See Cutsheet RSL0293 for available Parts and Accessories
5B	Turbine Fuel Filter - 1000MA Series See Cutsheet RSL0293 for available Parts and Accessories

2



3

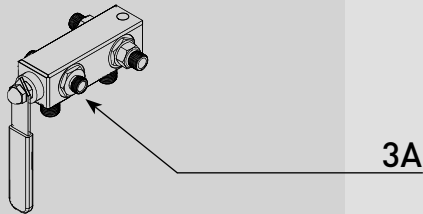

4

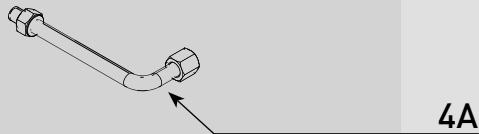

5

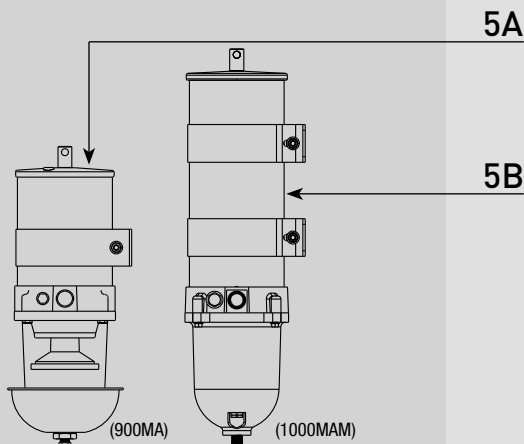

Accessories and Parts Available (Not Shown)

6A RK 11-1952	Complete Seal Service Kit - 900MA/1000MA Series Filters (<i>Requires 2</i>)
6B RK 21069 RK23191	WIF Probe (pig tail) - 1/2"-20 UNF - Requires 6C WIF Probe (Steel/pig tail) - 1/2"-20 UNF - Requires 6C
6C RK 14329 RK 14321	Water Detection Module - 12 vdc Water Detection Module - 24 vdc
6D RK 19506	Valve Service Kit - Includes Handle/Stem/O-rings/Gasket
7A	Bowl Gasket - Included in 6A
7B RK 11-1606-1	MA Bowl Kit (Clear) - Includes 7A, 7E & 7H (Gasket & O-ring only)
7C RK 11734-03	MAM Bowl Kit (Metal) - Includes 7A, 7D & 7G
7D RK 20022	Metal Bowl Plug Kit (MAM) (O-ring Included in 6A)
7E RK 20126	Plastic Bowl Plug Kit (MA) (O-ring Included in 6A)
7F RK 11868	Heat Deflector Kit (MA) - Includes 7H
7G	Drain Plug (MAM) - <i>Contact Technical Support</i>
7H RK 11-1910	Drain Plug Kit (MA) (Gasket & O-ring Included in 6A)
8A 2040N-02 2040N-10 2040N-30	900MA/MAM Replacement Element 2 micron 900MA/MAM Replacement Element 10 micron 900MA/MAM Replacement Element 30 micron
8B 2020N-02 2020N-10 2020N-30	1000MA/MAM Replacement Element 2 micron 1000MA/MAM Replacement Element 10 micron 1000MA/MAM Replacement Element 30 micron

Valve Operations

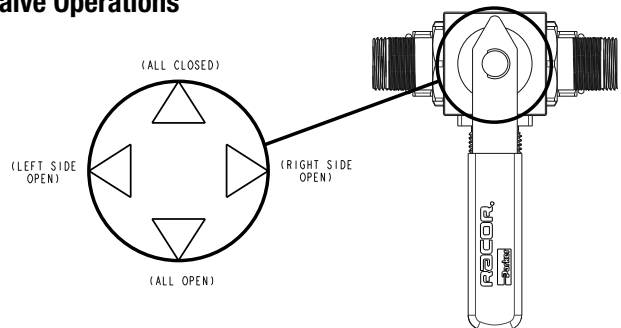

See **RSL0293**
For 900MA/1000MA Parts Breakdown

Turbine Series - 751000MAV-MAVM

FUEL

Specifications:

Height: MAV - 21.32" (54.15 cm)
 MAVM - 20.8" (52.8 cm)
Width: 15.0" (38.1 cm)
Depth: 11.8" (29.9 cm) with Bracket
Weight: MAV - 35 lbs (16 kg)
 MAVM - 37 lbs (16.8 kg)
Ports: 3/4"-14 NPT
Service Clearance (Top): 10.0" (25.4 cm)
Vacuum Installation Recommended
Maximum Pressure: 15 psi (1.03 bar)
Max Flow Rate: 360 gph (1363 lph)

Create a Part Number

Assembly Type	Double Assembly - Valves 180/360 gph Flow Rate	Filter Model	Turbine Model - Marine 180 gph Flow Rate (X2)	Model Type	Valves	Metal Bowl Option	Metal Bowl	Filtration Rating	2 micron	10 micron	30 micron
	75		1000MA		V		M		2	10	30

RACOR®

Dimensions:

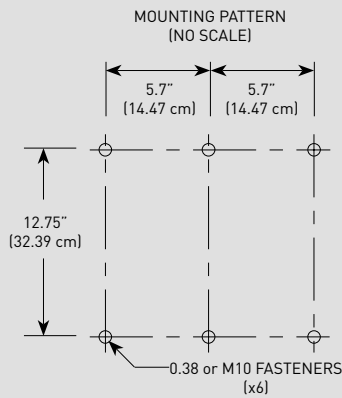

ASSEMBLY	DESCRIPTION
751000MAV10, 751000MAV30	Double Manifold 1000 Turbine Assy., 10 or 30 micron Filter
751000MAVM2	Double Manifold 1000 Turbine Assy., Metal Bowl, 2 micron Filter

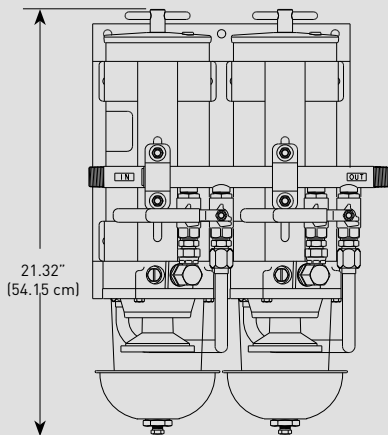
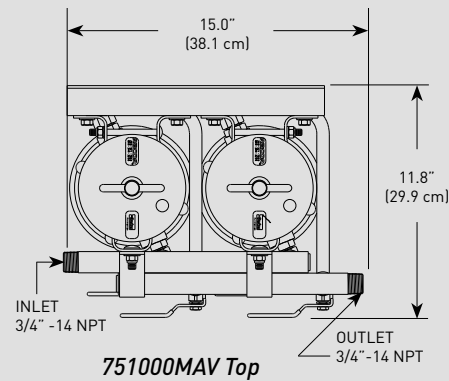

751000MAV Front

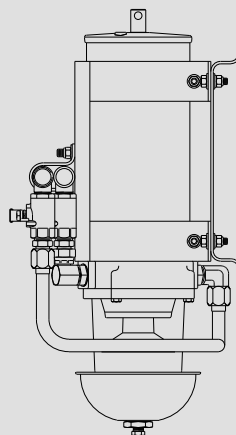

751000MAV Profile

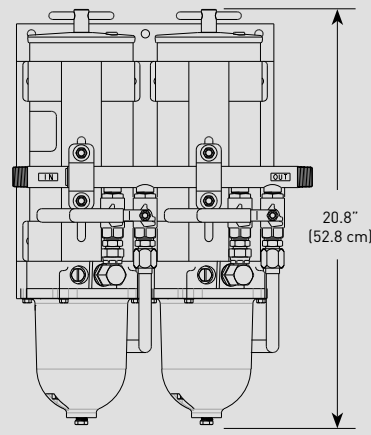

751000MAVM Front

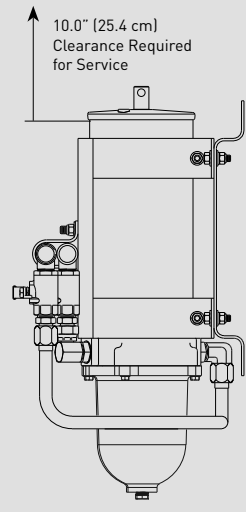

751000MAVM Profile

DUAL ASSEMBLIES



PARTS

Turbine Series - 751000MAV-MAVM

1

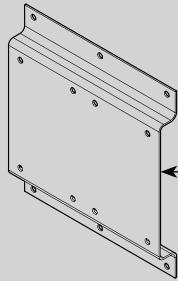

1A

Part #	Description
1A	Main Mounting Bracket - <i>Contact Technical Support</i>
2A	Manifold Assembly Bracket - <i>Contact Technical Support</i>
3A	RK 11073 Ball Valve Assembly (<i>uses 4</i>)
4A	Manifold tube - <i>Contact Technical Support</i>
5A	11-1761 U-bracket (<i>uses 2</i>)
6A	Turbine Fuel Filter - 1000MA/MAM Series (<i>Uses 2</i>) See Cutsheet RSL0293 for available Parts and Accessories

2

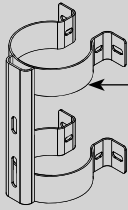

2A

3

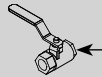

3A

4

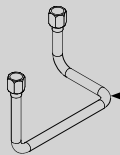

4A

5



5A

6

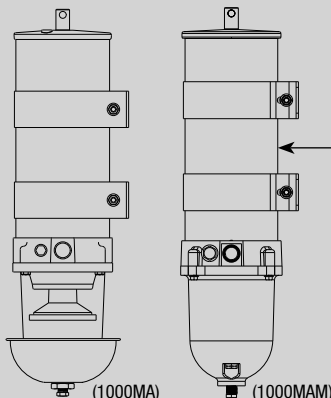

6A

Accessories and Parts Available (Not Shown)

7A	RK 11-1404	Complete Seal Service Kit - 1000MA/MAM Series Filters (<i>Requires 2</i>)
7B	RK 21069 RK23191	WIF Probe - 1/2"-20 UNF - 2-wire (MA) - Requires 7C * WIF Probe - Stainless Steel - 1/2"-20 UNF - 2-wire (MAM) - Requires 7C *
7C	RK 14329 RK 14321	Water Detection Module - 12 vdc Water Detection Module - 24 vdc
8A		Bowl Gasket - Included in 7A
8B	RK 11-1606-1	MA Bowl Kit (Clear) - Includes 8A, 9B & 9F (Gasket & O-ring only)
8C	RK 11734-03	MAM Bowl Kit (Metal) - Includes 8A, 9A, 9D and 10B
9A	RK 20022	Metal Bowl Plug Kit (MAM) (O-ring Included in 7A)
9B	RK 20126	Plastic Bowl Plug Kit (MA) (O-ring Included in 7A)
9C	RK 11868	Heat Deflector Kit (MA) - Includes 9F
9D		Drain Plug (MAM) - <i>Contact Technical Support</i>
9E	RK 11-1910	Drain Plug Kit (MA) (Gasket & O-ring Included in 7A)
10A	RK 11037A-01	Bowl Ring Kit (For MA Only - White) - Includes 8A & 10B
10B	RK 11542	Cap Screw Bowl Ring Fasteners (set of 4)
11A	2020N-02 2020N-10 2020N-30	1000MA/MAM Replacement Element 2 micron (<i>uses 3</i>) 1000MA/MAM Replacement Element 10 micron (<i>uses 3</i>) 1000MA/MAM Replacement Element 30 micron (<i>uses 3</i>)

* Note: If all units are used simultaneously, one probe or sensor can be used. If units are used as backups, then a probe or sensor should be installed in each bowl. Multiple probes can be wired in parallel to a single detection module.

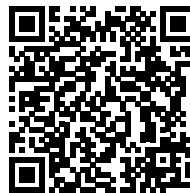

Online Link
Turbine Series Selector



Online Link
Turbine Series
Replacement Parts Selector

See **RSL0293**
For 1000MA/MAM Parts Breakdown

Specifications:

Height: 21.8" (55.37 cm)

Width: 16.5" (41.91 cm) with Bracket

Depth: 12.0" (30.48 cm) with Bracket

Weight: 26.0 lbs (11.8 kg)

Ports: 3/4"-14 NPT

Service Clearance (Top): 10.0" (25.4 cm)

Vacuum Installation Recommended

Maximum Pressure: 15 psi (1.03 bar)

Max Flow Rate: 360 gph (1362 lph)

Create a Part Number

Housing Type	Dual Assembly 360 GPH Flow Rate	Filter Model	Turbine Model 180 GPH Flow Rate (X2)	Filtration Rating	2 micron	10 micron	30 micron
	73		1000FH		2	10	30

RACOR®

Dimensions:

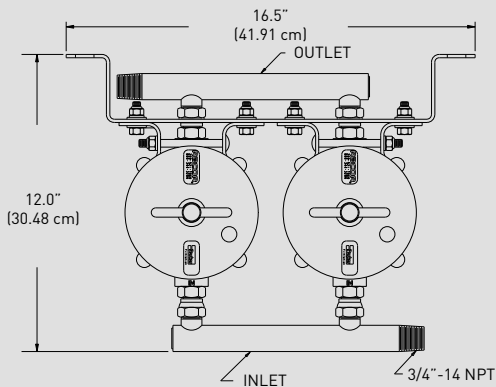

731000FH Top

ASSEMBLY	DESCRIPTION
731000FH2	Dual 1000 Turbine Assy., 2 micron Filter
731000FH10	Dual 1000 Turbine Assy., 10 micron Filter
731000FH30	Dual 1000 Turbine Assy., 30 micron Filter

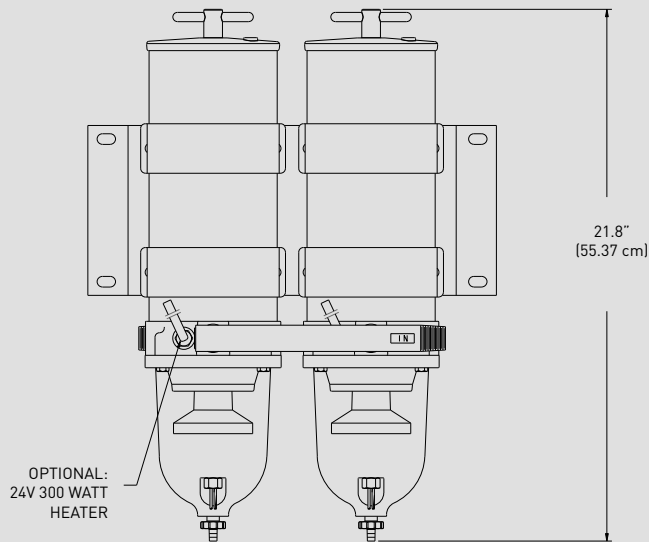
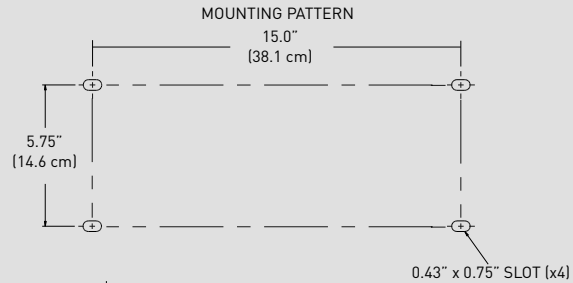

731000FH Front

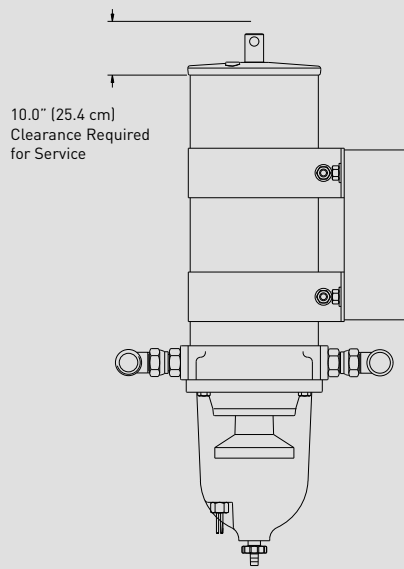

731000FH Profile

DUAL ASSEMBLIES



PARTS

Turbine Series - 731000FH

1

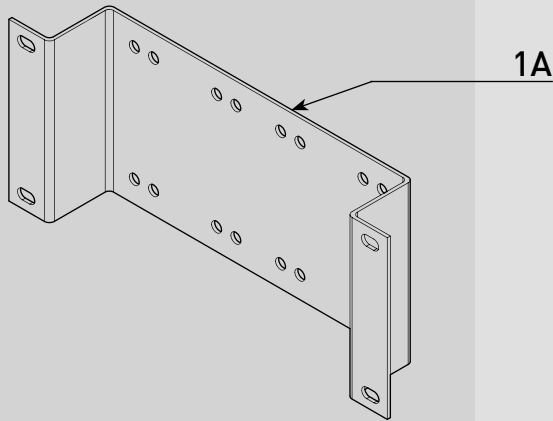

Part #	Description
1A 11065	Mounting Bracket - 731000FH - Bracket only
2A RK 11892	Inlet/Outlet Manifold Tube (3/4"-14 NPT)
3A	Turbine Fuel Filter - 1000FH Series See Cutsheet RSL0292 for available Parts and Accessories

Accessories and Parts Available (Not Shown)

6A	RK 11-1952	Complete Seal Service Kit - 900FH/1000FH Series Filters (Requires 2)
	RK 11-1404	Complete Seal Service Kit - 900/1000 Series Filters For FG and Older Models (Requires 2)
6B	RK30880E	WIF Sensor and Light Kit - 1/2"-20 UNF
	RK33802	WIF Probe Kit - 1/2"-20 UNF - Two Wire Pigtail Water Detection Module Required - Use 6C
6C	RK 14329	Water Detection Module - 12 vdc
	RK 14321	Water Detection Module - 24 vdc

2

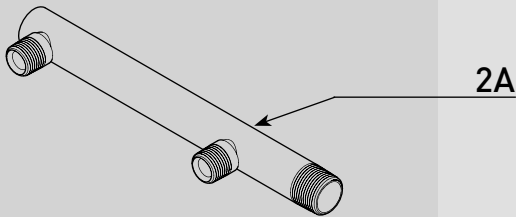

7A		Bowl Gasket - Included in 6A
7B	RK 11-1938	Bowl Kit - Includes 7A, 7C & 7D
7C	RK 20126	Bowl Plug (O-ring Included in 6A)
7D		Self-venting Drain (O-ring Included in 6A)

3

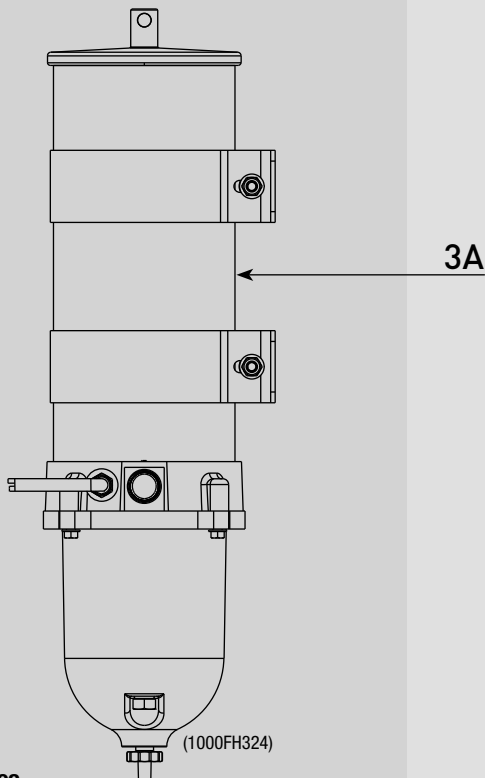

8A	2020N-02	1000FH Replacement Element 2 micron
	2020N-10	1000FH Replacement Element 10 micron
	2020N-30	1000FH Replacement Element 30 micron

See **RSL0292**
For 1000FH Parts Breakdown

Turbine Series - 731000MA-MAM

FUEL

Specifications:

- Height:** MA - 22.0" (55.9 cm)
MAM - 20.8" (52.8 cm)
- Width:** 16.5" (41.91 cm) with Bracket
- Depth:** 9.5" (24.13 cm) with Bracket
- Weight:** MA - 26.0 lbs (11.8 kg)
MAM - 28.0 lbs (12.7 kg)
- Ports:** 3/4"-14 NPT
- Service Clearance (Top):** 10.0" (25.4 cm)
- Vacuum Installation Recommended**
- Maximum Pressure:** 15 psi (1.03 bar)
- Max Flow Rate:** 360 gph (1362 lph)

Create a Part Number

Housing Type	Dual Assembly 360 GPH Flow Rate
73	
Filter Model	Turbine Model Marine 180 GPH Flow Rate (X2)
1000MA	
Assembly Options	Metal Bowl Option *
M	
Filteration Rating	2 micron 10 micron 30 micron *
2 10 30	

* Metal Bowl option only available with 30 micron filter

Dimensions:

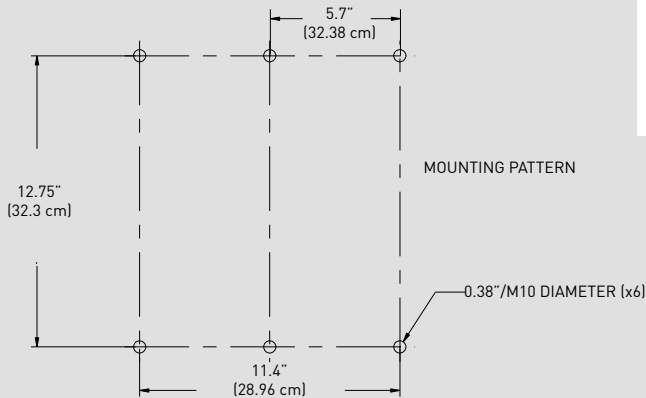

ASSEMBLY	DESCRIPTION
731000MA2	Marine - Dual 1000 Turbine Assy., 2 micron Filter
731000MA10	Marine - Dual 1000 Turbine Assy., 10 micron Filter
731000MA30	Marine - Dual 1000 Turbine Assy., 30 micron Filter
731000MAM30	Marine - Metal Bowl - Dual 1000 Turbine Assy., 30 micron Filter

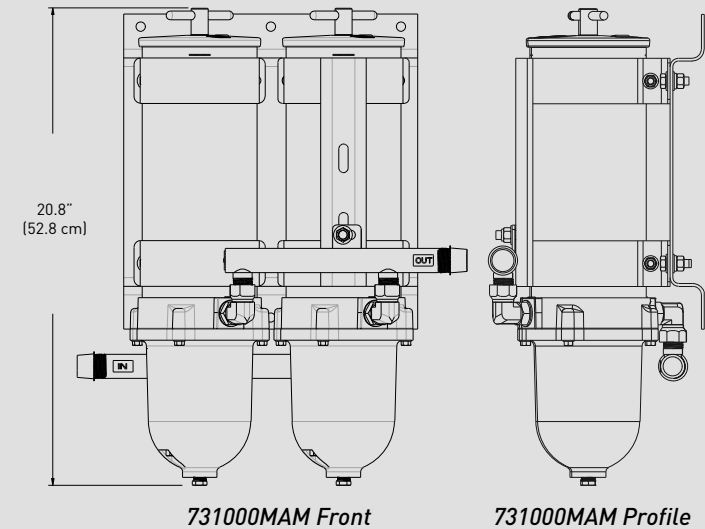
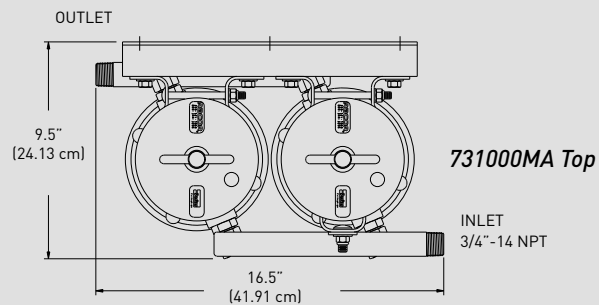
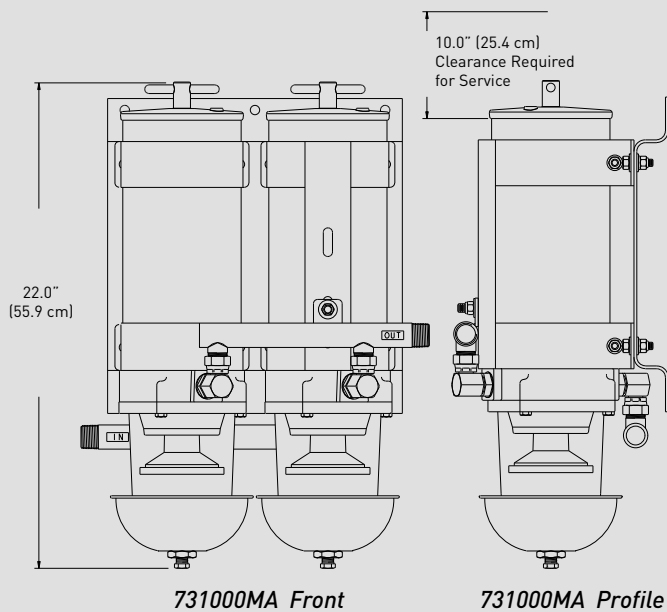

RACOR®

DUAL ASSEMBLIES



PARTS

Turbine Series - 731000MA-MAM

1

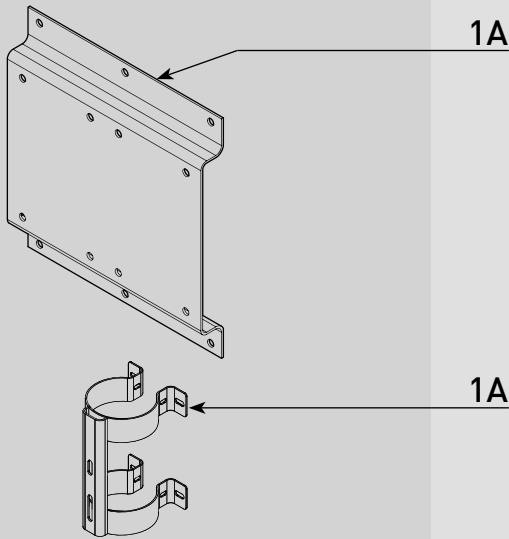

2

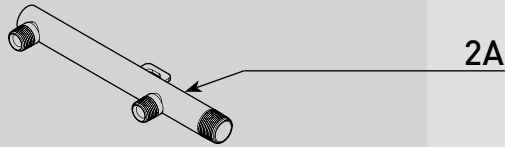

3

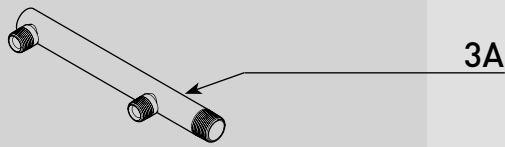

4

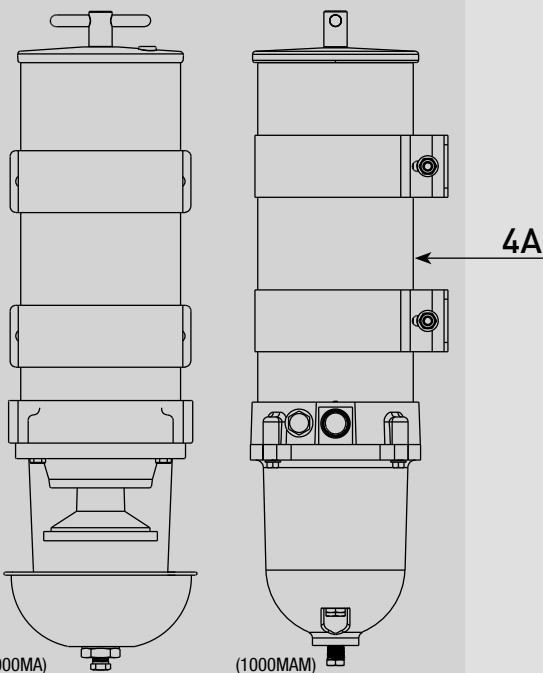

See **RSL0293**
For 1000MA Parts Breakdown

Part #	Description
1A	Mounting Bracket - <i>Contact Technical Support</i>
1B	Manifold Assembly Bracket - <i>Contact Technical Support</i>
2A	Outlet Manifold Tube - <i>Contact Technical Support</i> Outlet Manifold Tube - <i>Contact Technical Support</i>
3A	RK 11892 Inlet Manifold Tube (3/4"-14 NPT) (Beige Color)
4A	Turbine Fuel Filter - 1000MA Series See Cutsheet RSL0293 for available Parts and Accessories

Accessories and Parts Available (Not Shown)

5A	RK 11-1404	Complete Seal Service Kit - 1000MA Series Filters (Requires 2)
5B	RK 21069 RK23191	WIF Probe (pig tail) - 1/2"-20 UNF - Requires 5C WIF Probe (Steel/pig tail) - 1/2"-20 UNF - Requires 5C
5C	RK 14329 RK 14321	Water Detection Module - 12 vdc Water Detection Module - 24 vdc
6A		Bowl Gasket - Included in 5A
6B	RK 11-1606-1	MA Bowl Kit (Clear) - Includes 6A, 6C, Gasket & O-ring
6C	RK 20126	Plastic Bowl Plug Kit (MA) (O-ring Included in 5A)
6D	RK 11868	Heat Deflector Kit (MA) - Includes 6E
6E	RK 11-1910	Drain Plug Kit (MA) (Gasket & O-ring Included in 5A)
7A	2020N-02 2020N-10 2020N-30	1000MA Replacement Element 2 micron 1000MA Replacement Element 10 micron 1000MA Replacement Element 30 micron

Certifications

<p>Model MA</p>	<p>Model MAM</p>
----------------------------	-----------------------------



Online Link
Turbine Series Selector



Online Link
Turbine Series
Replacement Parts Selector

Turbine Series - 771000FH

FUEL

Specifications:

- Height: 22.0" (55.88 cm)
- Width: 21.25" (53.98 cm) with Bracket
- Depth: 12.3" (31.24 cm) with Bracket
- Weight: 39.0 lbs (17.7 kg)
- Ports: 1"-11 1/2 NPT
- Service Clearance (Top): 10.0" (25.4 cm)
- Vacuum Installation Recommended
- Maximum Pressure: 15 psi (1.03 bar)
- Max Flow Rate: 540 gph (2044 lph)

Create a Part Number

Housing Type	Filter Model	Filtration Rating
Triple Assembly 540 GPH Flow Rate	Turbine Model 180 GPH Flow Rate (X3)	2 micron 10 micron 30 micron
77	1000FH	2 10 30

RACOR®

Dimensions:

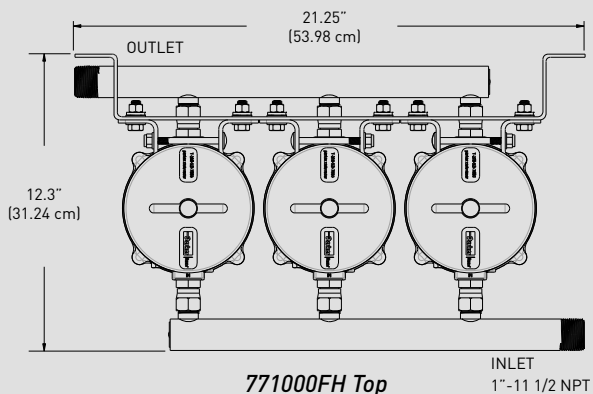

ASSEMBLY	DESCRIPTION
771000FH2	Triple 1000 Turbine Assy., 2 micron Filter
771000FH10	Triple 1000 Turbine Assy., 10 micron Filter
771000FH30	Triple 1000 Turbine Assy., 30 micron Filter

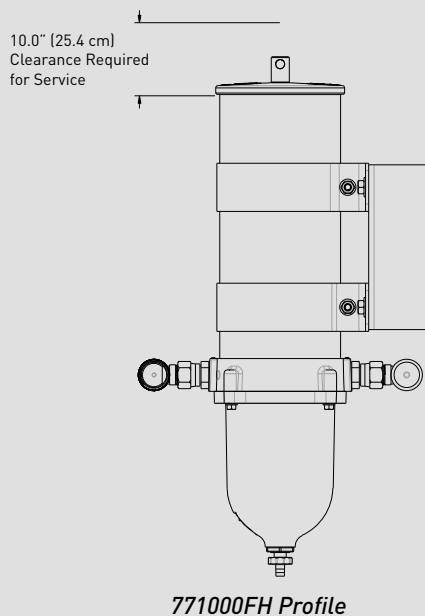
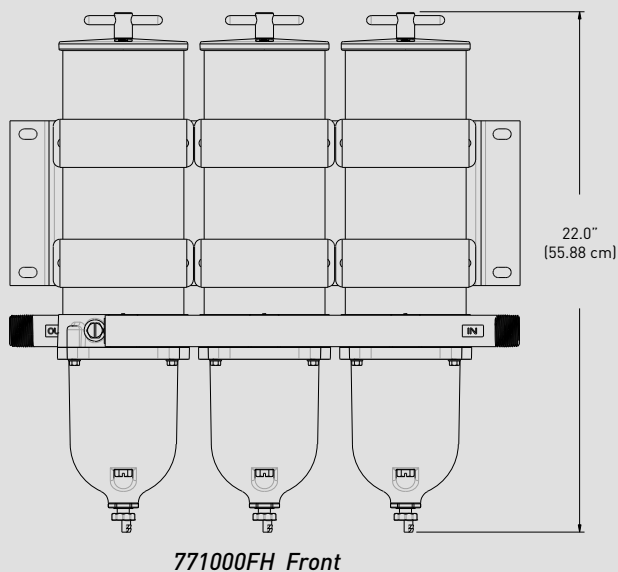
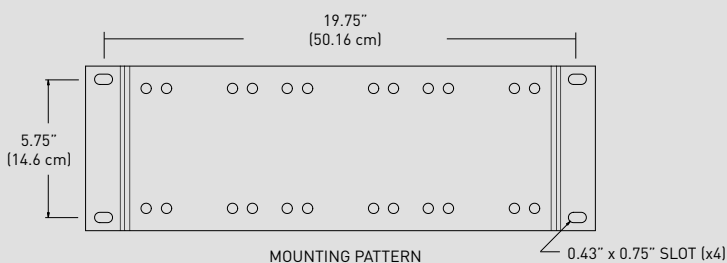

TRIPLE ASSEMBLIES



PARTS

Turbine Series - 771000FH

1

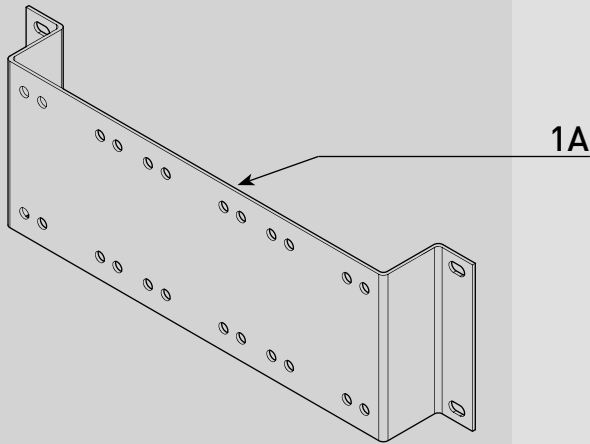

Part #	Description
1A	Mounting Bracket - <i>Contact Technical Support</i>
2A	Inlet/Outlet Manifold Tube - <i>Contact Technical Support</i>
3A	Turbine Fuel Filter - 1000FH Series See Cutsheet RSL0292 for available Parts and Accessories

Accessories and Parts Available (Not Shown)

4A	RK 11-1952	Complete Seal Service Kit - 900FH/1000FH Series Filters (Requires 2)
	RK 11-1404	Complete Seal Service Kit - 900/1000 Series Filters For FG and Older Models (Requires 2)
4B	RK30880E	WIF Sensor and Light Kit - 1/2"-20 UNF
	RK33802	WIF Probe Kit - 1/2"-20 UNF - Two Wire Pigtail Water Detection Module Required - Use 4C
4C	RK 14329	Water Detection Module - 12 vdc
	RK 14321	Water Detection Module - 24 vdc

5A		Bowl Gasket - Included in 4A
5B	RK 11-1938	Bowl Kit - Includes 5A, 5C & 5D
5C	RK 20126	Bowl Plug (O-ring Included in 4A)
5D		Self-venting Drain (O-ring Included in 4A)

6A	2020N-02	1000FH Replacement Element 2 micron
	2020N-10	1000FH Replacement Element 10 micron
	2020N-30	1000FH Replacement Element 30 micron

2

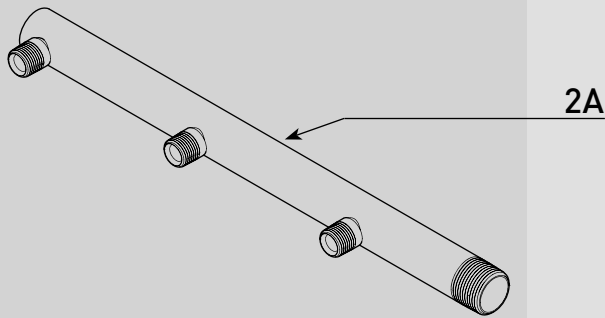

3

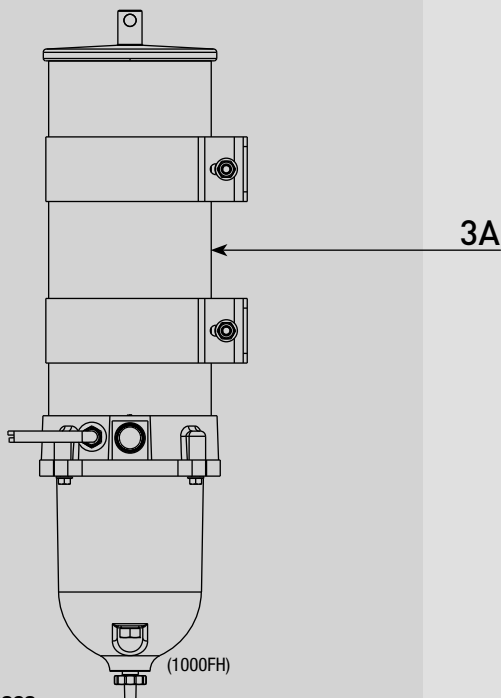

See **RSL0292**
For 1000FH Parts Breakdown



Online Link
Turbine Series Selector



Online Link
Turbine Series
Replacement Parts Selector

Turbine Series - 771000MA-MAM

FUEL

Specifications:

- Height: 22.0" (55.88 cm)
- Width: 21.25" (53.98 cm) with Bracket
- Depth: 12.3" (31.24 cm) with Bracket
- Weight: MA - 39 lbs (17.7 kg)
MAM - 42 lbs (19.1 kg)
- Ports: 3/4"-14 NPT
- Service Clearance (Top): 10.0" (25.4 cm)
- Vacuum Installation Recommended
- Maximum Pressure: 15 psi (1.03 bar)
- Max Flow Rate: 540 gph (2044 lph)

Create a Part Number

Housing Type	Filter Model	Assembly Options	Filteration Rating
Triple Assembly 540 GPH Flow Rate	Turbine Model 180 GPH Flow Rate (X3)	Metal Bowl Option *	10 micron 30 micron *
77	1000MA	M	10 30

RACOR®

* Metal bowl option only available with 30 micron element

Dimensions:

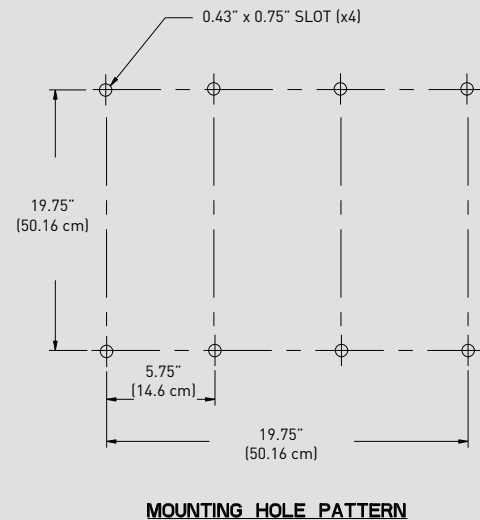
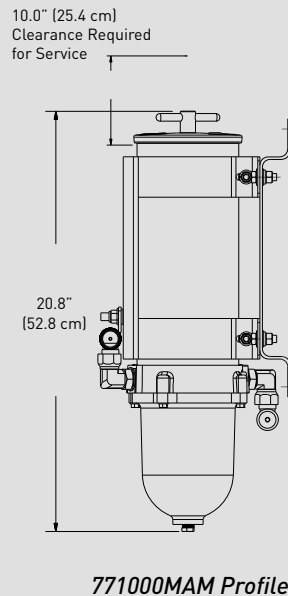
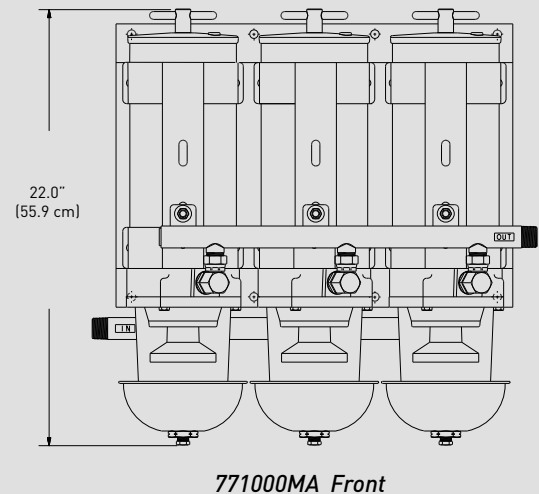
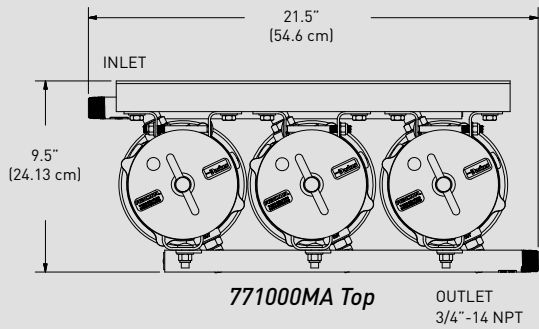

ASSEMBLY	DESCRIPTION
771000MA10	Marine - Triple 1000 Turbine Assy., 10 micron Filter
771000MA30	Marine - Triple 1000 Turbine Assy., 30 micron Filter
771000MAM30	Marine - Metal Bowl - Triple 1000 Turbine Assy., 30 micron Filter



TRIPLE ASSEMBLIES

PARTS

Turbine Series - 771000MA-MAM

1

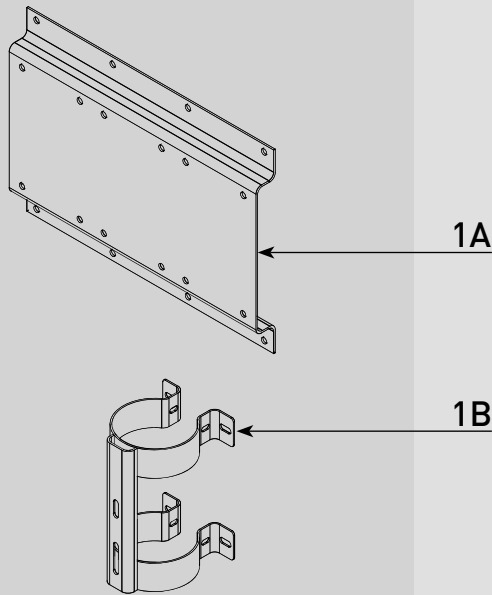

2

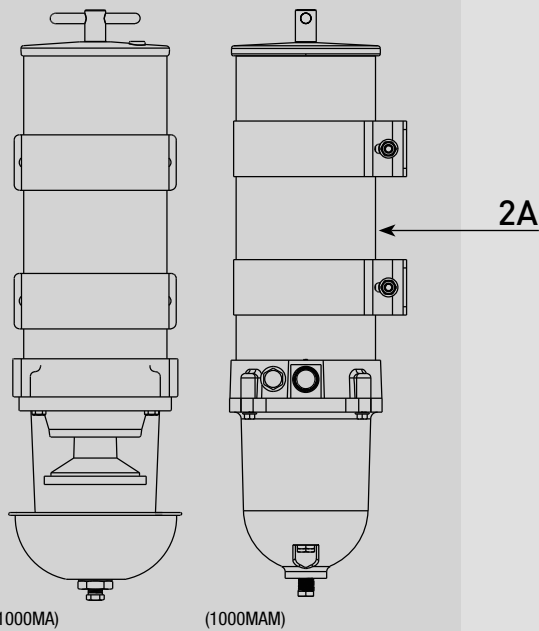







See **RSL0293**
For 1000MA-MAM Parts Breakdown

Part #	Description
1A	Mounting Bracket - <i>Contact Technical Support</i>
1B	Manifold Assembly Bracket - <i>Contact Technical Support</i>
2A	Turbine Fuel Filter - 1000MA Series See Cutsheet RSL0293 for available Parts and Accessories

Accessories and Parts Available (Not Shown)

3A	RK 11-1404	Complete Seal Service Kit - 1000MA Series Filters (Requires 3)
	RK 21069	WIF Probe (pig tail) - 1/2"-20 UNF - Requires Water Detection Module - Use 3C
3B	RK23191	WIF Probe (Steel/pig tail) - 1/2"-20 UNF - Requires Water Detection Module - Use 3C
3C	RK 14329	Water Detection Module - 12 vdc
	RK 14321	Water Detection Module - 24 vdc
4A		Bowl Gasket - Included in 5A
4B	RK 11-1606-1	MA Bowl Kit (Clear) - Includes 4A, 4C, Gasket & O-ring
4C	RK 20126	Plastic Bowl Plug Kit (MA) (O-ring Included in 3A)
4D	RK 11868	Heat Deflector Kit (MA) - Includes 4E
4E	RK 11-1910	Drain Plug Kit (MA) (Gasket & O-ring Included in 3A)
5A	2020N-02	1000MA Replacement Element 2 micron
	2020N-10	1000MA Replacement Element 10 micron
	2020N-30	1000MA Replacement Element 30 micron

Certifications

<p>Model MA</p>  <p>LISTED</p> 	<p>Model MAM</p>  <p>LISTED</p>   <p>Setting Standards for Safer Boating</p>  
---	--



Online Link
Turbine Series Selector



Online Link
Turbine Series
Replacement Parts Selector

Turbine Series - 791000FHV

FUEL

Specifications:

- Height: 21.32" (54.15 cm)
- Width: 21.44" (54.47 cm) with Bracket
- Depth: 11.7" (29.7 cm) with Bracket
- Weight: 52.0 lbs (24.0 kg)
- Ports: 3/4"-14 NPT
- Service Clearance (Top): 10.0" (25.4 cm)
- Vacuum Installation Recommended
- Maximum Pressure: 15 psi (1.03 bar)
- Max Flow Rate: 540 gph (2044 lph)

Create a Part Number

Assembly Type	Triple Assembly - Valves	Filter Model	Turbine Model	Model Type	Heater Option	Filtration Rating
	180/360/540 gph Flow Rate		180 gph Flow Rate (X3)			
79	1000FH	V	324	2	10	30

** - Heater only available with 30 micron assemblies

Dimensions:

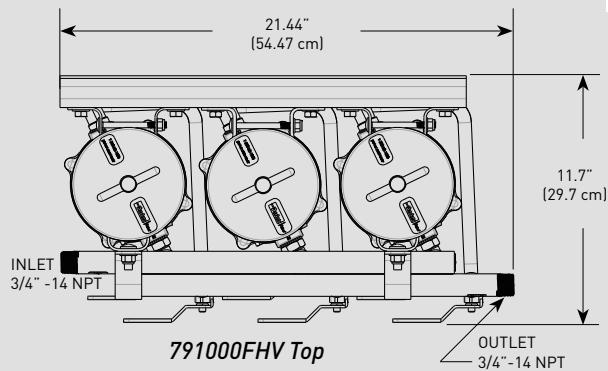

791000FHV Top

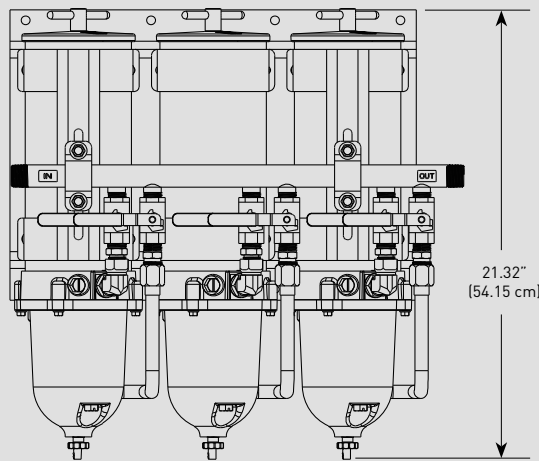

791000FHV Front

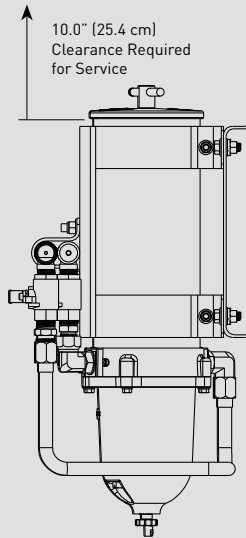

791000FHV Profile

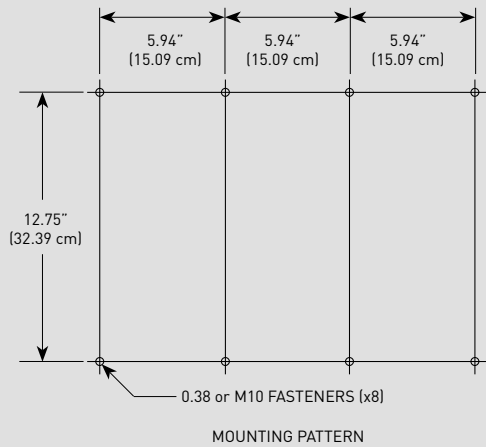

ASSEMBLY	DESCRIPTION
791000FHV2	Triple Manifold 1000 Turbine Assy., 2 micron Filter
791000FHV10	Triple Manifold 1000 Turbine Assy., 10 micron Filter
791000FHV30	Triple Manifold 1000 Turbine Assy., 30 micron Filter
791000FHV32430	Triple Manifold 1000 Turbine Assy., 24V Heater, 30 micron Filter

RACOR®

TRIPLE ASSEMBLIES



PARTS

Turbine Series - 791000FHV

1

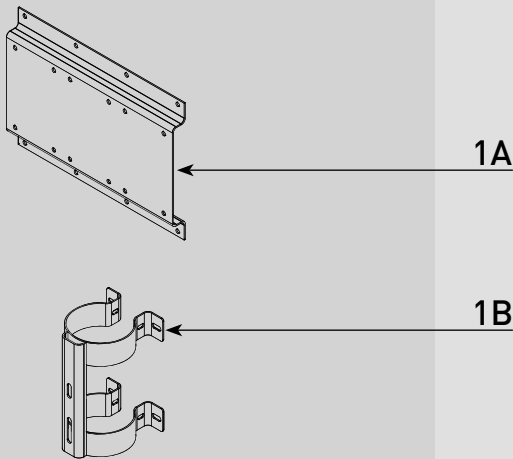

Part #	Description
1A	Mounting Bracket - <i>Contact Technical Support</i>
1B	Manifold Assembly Bracket - <i>Contact Technical Support</i>
2A	19460 Inlet Manifold Tube (3/4"-14 NPT) - (Tan)
2B	19461 Outlet Manifold Tube (3/4"-14 NPT) - (Tan)
3A	RK 11073 Ball Valve Assembly (uses 6)
4A	Manifold tube - <i>Contact Technical Support</i>
5A	11-1761 U-bracket (uses 2)
6A	Turbine Fuel Filter - 1000FH Series (Uses 3) See Cutsheet RSL0292 for available Parts and Accessories

2

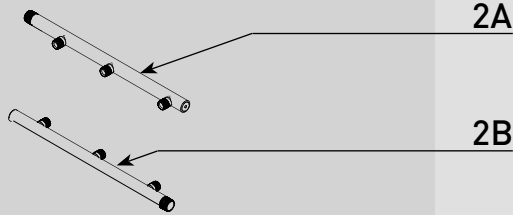

Accessories and Parts Available (Not Shown)

7A	RK 11-1952	Complete Seal Service Kit - 1000FH Series Filters (Requires 3)
	RK 11-1404	Complete Seal Service Kit - 1000 Series Filters For FG and Older Models (Requires 3)
7B	RK30880E	WIF Sensor and Light Kit - 1/2"-20 UNF *
	RK33802	WIF Probe Kit - 1/2"-20 UNF - Two Wire Pigtail * Water Detection Module Required - Use 7C
7C	RK 14329	Water Detection Module - 12 vdc
	RK 14321	Water Detection Module - 24 vdc

3



8A		Bowl Gasket - Included in 7A
8B	RK 11-1938	Bowl Kit - Includes 8A, 8C & 8D
8C	RK 20126	Bowl Plug (O-ring Included in 7A)
8D		Self-venting Drain (O-ring Included in 7A)

4



9A	2020N-02	1000FH Replacement Element 2 micron (uses 3)
	2020N-10	1000FH Replacement Element 10 micron (uses 3)
	2020N-30	1000FH Replacement Element 30 micron (uses 3)

5



* Note: If all 3 units are used simultaneously, one probe or sensor can be used. If units are used as backups, then a probe or sensor should be installed in each bowl. Multiple probes can be wired in parallel to a single detection module.

6

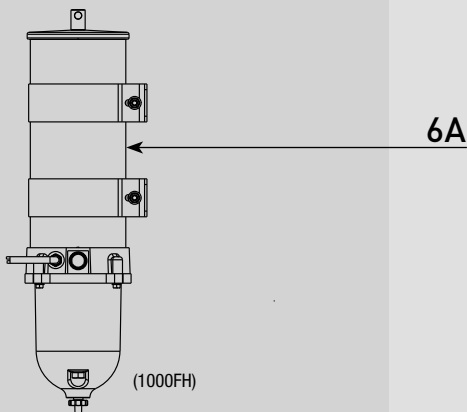

See **RSL0292**
For 1000FH Parts Breakdown



Online Link
Turbine Series Selector



Online Link
Turbine Series
Replacement Parts Selector

Turbine Series - 791000MAV-MAVM

FUEL

Specifications:

Height: MAV - 21.32" (54.15 cm)
 MAVM - 20.9" (53.1 cm)

Width: 21.5" (54.6 cm) with Bracket

Depth: 11.7" (29.7 cm) with Bracket

Weight: MAV - 52.0 lbs (22.2 kg)
 MAVM - 55.0 lbs (24.0 kg)

Ports: 3/4"-14 NPT

Service Clearance (Top): 10.0" (25.4 cm)

Vacuum Installation Recommended

Maximum Pressure: 15 psi (1.03 bar)

Max Flow Rate: 540 gph (2044 lph)

Create a Part Number

Assembly Type	Triple Assembly - Valves 180/360/540 gph Flow Rate	Filter Model	Turbine Model - Marine 180 gph Flow Rate (X3)	Model Type	Valves	Metal Bowl Option	Metal Bowl	Filtration Rating	2 micron 10 micron 30 micron
79	1000MA	V	M	2	10	30			

RACOR®

ASSEMBLY	DESCRIPTION
791000MAV2, 791000MAV10, 791000MAV30	Triple Manifold 1000 Turbine Assy., 2, 10, or 30 micron Filter
791000MAVM2, 791000MAVM10, 791000MAVM30	Triple Manifold 1000 Turbine Assy., Metal Bowl, 2, 10, or 30 micron Filter

Dimensions:

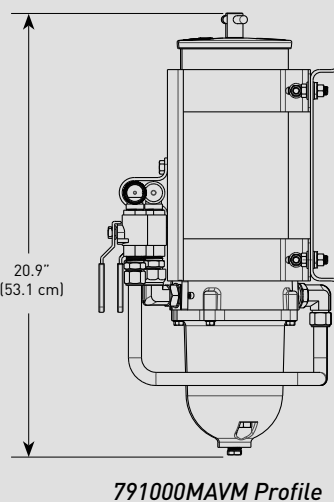
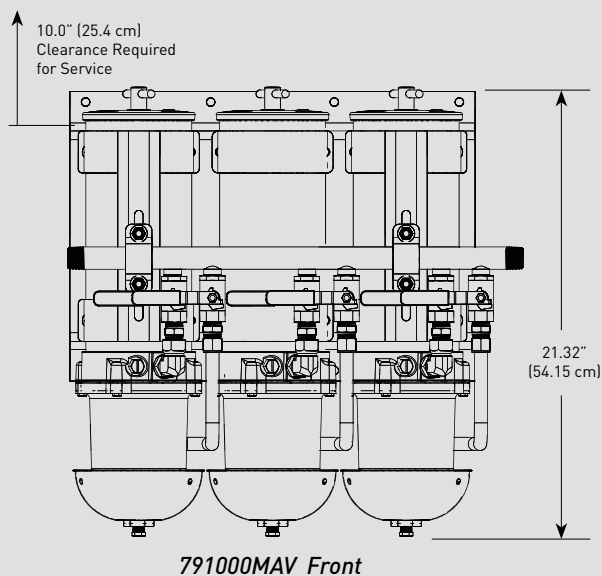
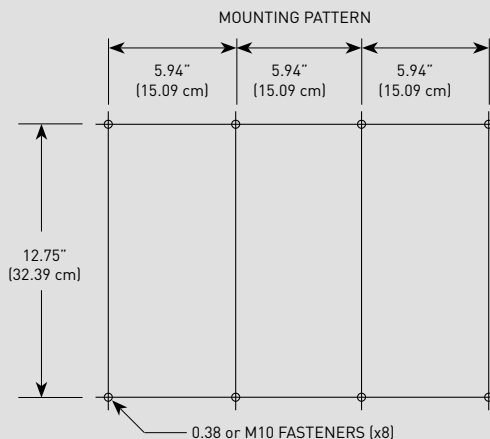
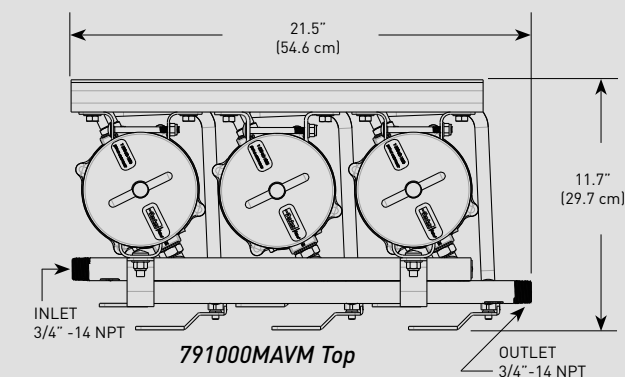

TRIPLE ASSEMBLIES

PARTS

Turbine Series - 791000MAV-MAVM

1

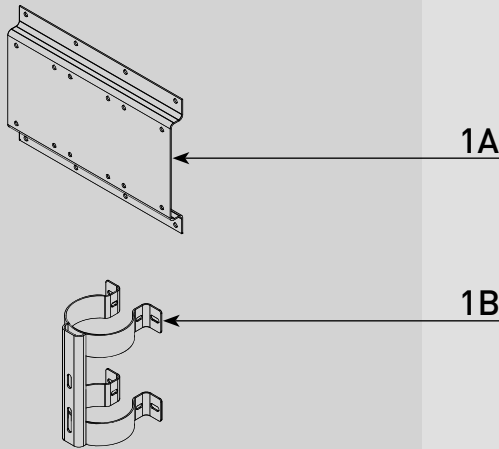

Part #	Description
1A	Main Mounting Bracket - <i>Contact Technical Support</i>
1B	Manifold Assembly Bracket - <i>Contact Technical Support</i>
2A	19460 Inlet Manifold Tube (3/4"-14 NPT) - (Tan)
2B	19461 Outlet Manifold Tube (3/4"-14 NPT) - (Tan)
3A	RK 11073 Ball Valve Assembly (<i>uses 6</i>)
4A	Manifold tube - <i>Contact Technical Support</i>
5A	11-1761 U-bracket (<i>uses 2</i>)
6A	Turbine Fuel Filter - 1000MA/MAM Series (<i>Uses 3</i>) See Cutsheet RSL0293 for available Parts and Accessories

2

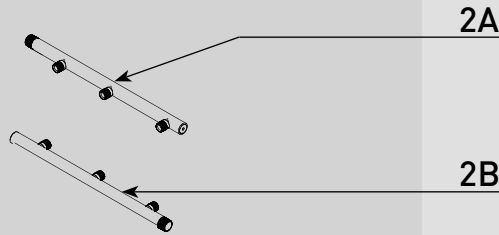

Accessories and Parts Available (<i>Not Shown</i>)		
7A	RK 11-1404	Complete Seal Service Kit - 1000MA/MAM Series Filters (<i>Requires 3</i>)
7B	RK 21069 RK23191	WIF Probe - 1/2"-20 UNF - 2-wire (MA) - Requires 7C * WIF Probe - Stainless Steel - 1/2"-20 UNF - 2-wire (MAM) - Requires 7C *
7C	RK 14329 RK 14321	Water Detection Module - 12 vdc Water Detection Module - 24 vdc

3



8A		Bowl Gasket - Included in 7A
8B	RK 11-1606-1	MA Bowl Kit (Clear) - Includes 8A, 9B & 9F (Gasket & O-ring only)
8C	RK 11734-03	MAM Bowl Kit (Metal) - Includes 8A, 9A, 9D and 10B

4



9A	RK 20022	Metal Bowl Plug Kit (MAM) (O-ring Included in 7A)
9B	RK 20126	Plastic Bowl Plug Kit (MA) (O-ring Included in 7A)
9C	RK 11868	Heat Deflector Kit (MA) - Includes 9F
9D		Drain Plug (MAM) - <i>Contact Technical Support</i>
9E	RK 11-1910	Drain Plug Kit (MA) (Gasket & O-ring Included in 7A)

5



10A	RK 11037A-01	Bowl Ring Kit (For MA Only - White) - Includes 8A & 10B
10B	RK 11542	Cap Screw Bowl Ring Fasteners (set of 4)

6

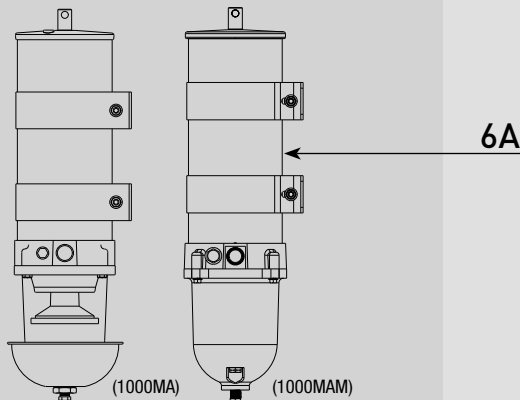

11A	2020N-02 2020N-10 2020N-30	1000MA/MAM Replacement Element 2 micron (<i>uses 3</i>) 1000MA/MAM Replacement Element 10 micron (<i>uses 3</i>) 1000MA/MAM Replacement Element 30 micron (<i>uses 3</i>)
-----	----------------------------------	---

* Note: If all 3 units are used simultaneously, one probe or sensor can be used. If units are used as backups, then a probe or sensor should be installed in each bowl. Multiple probes can be wired in parallel to a single detection module.

See **RSL0293**
For 1000MA/MAM Parts Breakdown

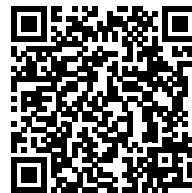

Online Link
Turbine Series Selector



Online Link
Turbine Series
Replacement Parts Selector

Turbine Series

Part Number Cross Reference

Part#	Page	Part#	Page	Part#	Page
11065	22	500FG2	3	75500MAX2	13
19460	30, 32	500FG242	3	75500MAX30	13
19461	30, 32	500FG2430	3	75500MAXM10	13
1000FH10	7	500FG30	3	75500MAXM2	13
1000FH2	7	500MA10	5	75500MAXM30	13
1000FH30	7	500MA2	5	75500MAXP30	13
1000FH31210	7	500MA30	5	75900FHX10	15
1000FH3122	7	500MAM10	5	75900FHX2	15
1000FH31230	7	500MAM2	5	75900FHX30	15
1000FH3242	7	500MAM30	5	75900MAX10	17
1000FH32430	7	731000FH10	21	75900MAX2	17
1000MA10	9	731000FH2	21	75900MAX30	17
1000MA2	9	731000FH30	21	75900MAXM10	17
1000MA30	9	731000MA10	23	75900MAXM2	17
1000MAM10	9	731000MA2	23	75900MAXM30	17
1000MAM2	9	731000MA30	23	75900MAXP30	17
1000MAM30	9	731000MAM30	23	771000FH10	25
1000MAP10	9	751000FHX10	15	771000FH2	25
11-1761	20, 30, 32	751000FHX2	15	771000FH30	25
2010PM-OR	4, 6, 12, 14	751000FHX30	15	771000MA10	27
2010SM-OR	4, 6, 12, 14	751000MAV10	19	771000MA30	27
2010TM-OR	4, 6, 12, 14	751000MAV30	19	771000MAM30	27
2020N-02	8, 10, 16, 18, 20, 22, 24, 26, 28, 30, 32	751000MAVM2	19	791000FHV10	29
2020N-10	8, 10, 16, 18, 20, 22, 24, 26, 28, 30, 32	751000MAX10	17	791000FHV2	29
2020N-30	8, 10, 16, 18, 20, 22, 24, 26, 28, 30, 32	751000MAX2	17	791000FHV30	29
2040N-02	8, 10, 16, 18	751000MAX30	17	791000FHV32430	29
2040N-10	8, 10, 16, 18	751000MAXM10	17	791000MAV10	31
2040N-30	8, 10, 16, 18	751000MAXM2	17	791000MAV2	31
500FG10	3	751000MAXM30	17	791000MAV30	31
500FG1230	3	751000MAXP10	17	791000MAVM10	31
		75500FGX10	11	791000MAVM2	31
		75500FGX2	11	791000MAVM30	31
		75500FGX30	11	900FH10	7
		75500MAX10	13	900FH2	7

Part#	Page
900FH30	7
900FH31230	7
900FH32430	7
900MA10	9
900MA2	9
900MA30	9
900MAM10	9
900MAM2	9
900MAM30	9
RK 11028B	8, 10
RK 11037A	8
RK 11037A-01	10, 20, 32
RK 11073	20, 30, 32
RK 11-1404	10, 16, 20, 22, 24, 26, 28, 30, 32
RK 11-1606-1	10, 18, 20, 24, 28, 32
RK 11-1679	4, 6, 8, 10
RK 11-1777	16, 18
RK 11-1910	6, 10, 14, 18, 20, 24, 28, 32
RK 11-1927-01	8
RK 11-1933-04	10
RK 11-1938	8, 16, 22, 26, 30
RK 11-1939	8, 10
RK 11-1952	8, 16, 18, 22, 28, 30
RK 11542	8, 10, 20, 32
RK 11734-03	10, 18, 20, 32
RK 11838	4, 6, 8
RK 11861	4
RK 11862	4
RK 11868	10, 18, 20, 24, 28, 32
RK 11892	22, 24
RK 14321	6, 8, 10, 12, 14, 16, 18, 20, 24, 26, 28, 30, 32
RK 14329	6, 8, 10, 12, 14, 16, 18, 20, 24, 26, 28, 30, 32
RK 15010B	4, 6
RK 15013D	4, 6

Part#	Page
RK 15035	4
RK 15035-01	6, 14
RK 15078	4
RK 15081	4, 6, 14
RK 15104	6, 14
RK 15211	4, 6, 12, 14
RK 15279-01	4, 6, 12, 14
RK 15301-02	6, 14
RK 15390	12, 14
RK 15391	12, 14
RK 15419	12, 14
RK 19473	16, 18
RK 19475	16, 18
RK 19486	16, 18
RK 19492	6
RK 19506	16, 18
RK 20022	6, 10, 14, 18, 20, 32
RK 20126	4, 6, 8, 10, 12, 14, 16, 18, 20, 22, 24, 26, 28, 30, 32
RK 20726	4
RK 21069	6, 10, 14, 18, 20, 24, 28, 32
RK 30488	4, 12
RK11-1978	8, 10
RK11-2005	8, 10
RK11-2009	8
RK11-2010	8
RK11-2015	8
RK11-2016	8
RK15078-02	6
RK15374	4
RK15405	4, 12
RK15438-01	4
RK15440-02	4
RK15441-01	4, 6
RK19667	8, 10, 12, 14, 16, 18
RK19669	8, 10, 12, 14, 16, 18

Part#	Page
RK19671	4, 6, 8, 10
RK23183	4, 6, 8, 10
RK23191	6, 10, 14, 18, 20, 24, 28, 32
RK30880E	4, 8, 12, 16, 22, 26, 30
RK33802	4, 8, 12, 16, 22, 26, 30
RKP1912	8, 10
RKP1924	8, 10

⚠️ WARNING: The products described in this literature can expose you to chemicals including Diisononyl phthalate, Carbon black extract, which are known to the State of California to cause cancer. For more information go to www.P65Warnings.ca.gov.

All products manufactured or distributed by Racor are subject to the following, and only the following, LIMITED EXPRESS WARRANTIES, and no others: For a period of one (1) year from and after the date of purchase of a new Racor product, Racor warrants and guarantees only to the original purchaser-user that such a product shall be free from defects of materials and workmanship in the manufacturing process. The warranty period for pumps and motors is specifically limited to ninety (90) days from date of purchase. A product claimed to be defective must be returned to the place of purchase. Racor, at its sole option, shall replace the defective product with a comparable new product or repair the defective product. This express warranty shall be inapplicable to any product not properly installed and properly used by the purchaser-user or to any product damaged or impaired by external forces.

THIS IS THE EXTENT OF WARRANTIES AVAILABLE ON THIS PRODUCT. RACOR SHALL HAVE NO LIABILITY WHATSOEVER FOR CONSEQUENTIAL DAMAGES FLOWING FROM THE USE OF ANY DEFECTIVE PRODUCT OR BY REASON OF THE FAILURE OF ANY PRODUCT. RACOR SPECIFICALLY DISAVOWS ALL OTHER WARRANTIES, EXPRESS OR IMPLIED INCLUDING, WITHOUT LIMITATION, ALL WARRANTIES OF FITNESS FOR A PARTICULAR PURPOSE (EXCEPT FOR THOSE WHICH APPLY TO PRODUCT OR PART THEREOF THAT IS USED OR BOUGHT FOR USE PRIMARILY FOR PERSONAL, FAMILY, OR HOUSEHOLD PURPOSES), WARRANTIES OF DESCRIPTION, WARRANTIES OF MERCHANTABILITY, TRADE USAGE OR WARRANTIES OR TRADE USAGE.

Warning! Failure or improper selection or improper use of the products and/or systems described herein or related items can cause death, personal injury and property damage. This document and other information from Parker Hannifin Corporation, its subsidiaries and authorized distributors provide product and/or system options for further investigation by users having technical expertise. It is important that you analyze all aspects of your application and review the information concerning the product or system in the current product catalog. Due to the variety of operating conditions and applications for these products or systems, the user, through its own analysis and testing, is solely responsible for making the final selection of the products and systems and assuring that all performance, safety and warning requirements of the applications are met. The products described herein, including with limitation, product features, specifications, designs, availability and pricing, are subject to change by Parker Hannifin Corporation and its subsidiaries at any time without notice.

The following statement is required pursuant to proposition 65, applicable in the State of California: 'This product may contain a chemical known to the State of California to cause cancer or reproductive toxicity'.

